

1812 to EVOLVE 2100 Series Replacement Kit

DoorKing Part Numbers:

2112-581

Surface / Flush Mount Styles

2112-582

Surface Curved Mount Style

Prior to installing the replacement components of your existing 1812, we suggest that you thoroughly clean the 1812 and surrounding area. Be sure that all dirt, dust, cobwebs, metal or wood debris is removed from inside the unit. Any debris inside could damage the control board and cause the 2100 series system to malfunction during operation.

Included with the kit is an extra random keyed cabinet lock. If desired, for added security against unauthorized entry into the system, the standard lock may be replaced with the random lock on the new faceplate. Note: DoorKing cannot replace this specific lock or keys if lost.

Things to consider BEFORE replacing components:

- An existing 1812 Access**Plus** model controlling **MORE than 3** access points **CANNOT** be replaced with the 2112 circuit board.
- **Multiple** 1812s wired together **CANNOT** be replaced with 2112 circuit boards.
- The mounted height of your existing 1812 will determine the **field-of-view** of the new video lens. High profile vehicles may present a problem when viewing the person inside the vehicle if the video lens is mounted too low. The unit may need to be mounted at an upward angle or reinstalled higher to better view a person in a high profile vehicle.
- Communication connection for your upgraded system. Your existing telephone lines are **obsolete**. Choose either a DKS Cellular Module (monthly service charge with an **additional** cellular module, sold separately) **OR** connection to **YOUR existing** internet (**new** Cat5 cable must be run from **your router** to your existing 1812).
 - Checking the Cellular signal strength at the 1812 **BEFORE** removing any components if that is your chosen communication method. Additional height and protective housing may be necessary for the **NEW** cellular module (sold separately). Good cellular signal strength is **essential** for reliable communication.
 - Running a **NEW** Cat5 cable to the 1812 if that is your chosen communication method. After removing **ALL** existing obsolete telephone line wiring, the existing telephone conduit may be able to run a new Cat5 cable through it. The maximum distance for a Cat5 cable is **325 feet**.
- Label all wires **BEFORE** removing them from the existing 1812 for easy rewiring to the new 2100 control board terminal.
- Replace the old 1812 power plug-in transformer with the new one included with this kit.
- Your **old** lock and **key** can be reinstalled and used if desired.
- Proper way to ground yourself **BEFORE** handling the 2100 control board.
- Make sure **ALL power is shut-off** before starting installation.
- Referencing the **2100 Series entry manual PDF** available at: www.doorking.com

Remove All Components from Your 1812

Components removal are the same for all 1812 models.

1. **Shut-OFF** power to 1812.
2. Unlock and open the 1812 door.
3. Disconnect the **keypad plug** and **faceplate accessories plug** from the control board.
4. Disconnect **ALL wiring** from **18-Pin terminal**, labeling the wires. Telephone wires are obsolete.
5. Remove **4 screws** to remove control board.
6. Remove **3 locknuts** from hinge to remove faceplate.

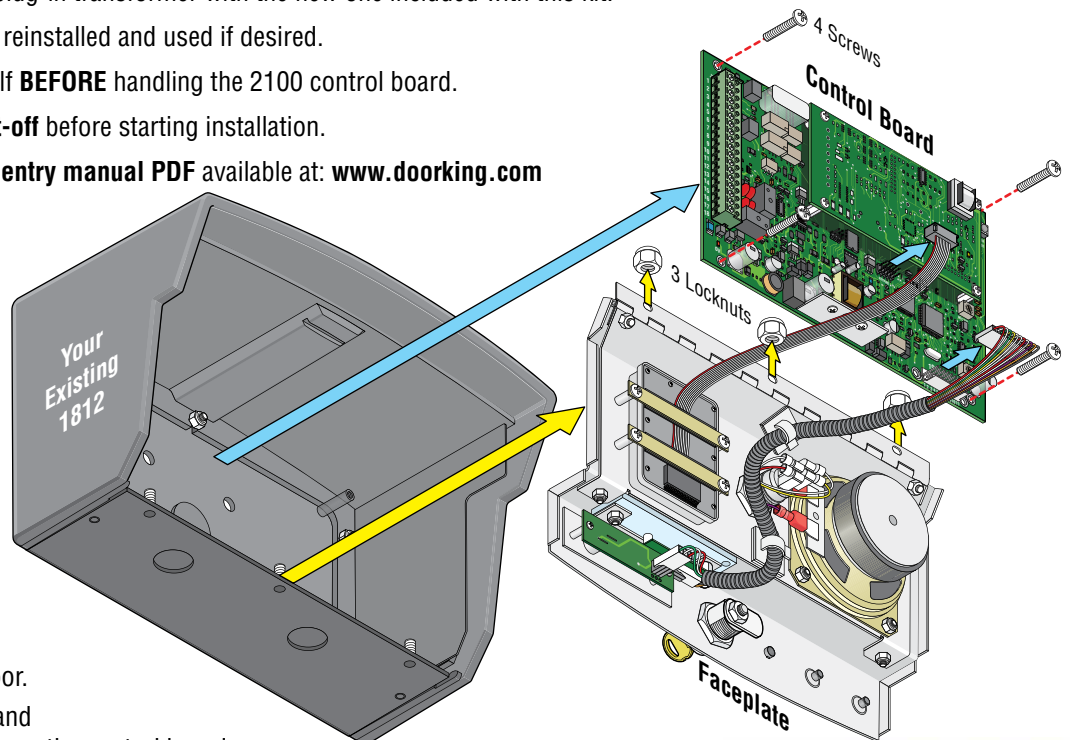

DKS
DOORKING
120 S. Glasgow Avenue
Inglewood, California 90301 U.S.A.

Replace All Components with NEW EVOLVE 2112 Components

Make sure that the housing is **CLEAN**. Any debris inside could damage the control board and cause the 2100 series system to malfunction during operation. Vacuum out inside if necessary.



Components replacement are the same for all 1812 models.

CAUTION The control board contains static sensitive components. Discharge any static electricity from your hands by touching a proper ground device **BEFORE** installing the control board.

1. Reattach the NEW faceplate using the **3 locknuts** to secure the hinge.

NOTE: A **NEW** Cat5 cable or **NEW** External cellular module cable must be run inside the cabinet **BEFORE** continuing installation. An **Internal** cellular module (Surface Curved model **ONLY**) does **NOT** require an external cable.

2. Carefully install the **NEW 2100 control board** routing existing wires around the board, using the **4 screws** in the corners of board to secure it.
3. Plug in the **keypad plug** and **faceplate accessories plug** as shown.
4. Lock in the **video ribbon** into video connector as shown in detail below.
5. At this point, the **2100 Series Entry manual** will be needed to complete your **SPECIFIC** installation needs. Rewiring your devices, programming, registering etc. are all explained in the manual.

Optional **INTERNAL** Cellular Module
(Curved Surface mount model **ONLY**)
NO external wiring needed
(see manual for more information)

Cellular Module

OR

USB Cable As short as possible

To Your Router connected to the Internet
Cat5 Cable 325 ft Max.

The cellular module is **OPTIONAL**. It **MUST** be registered **BEFORE** it will function.

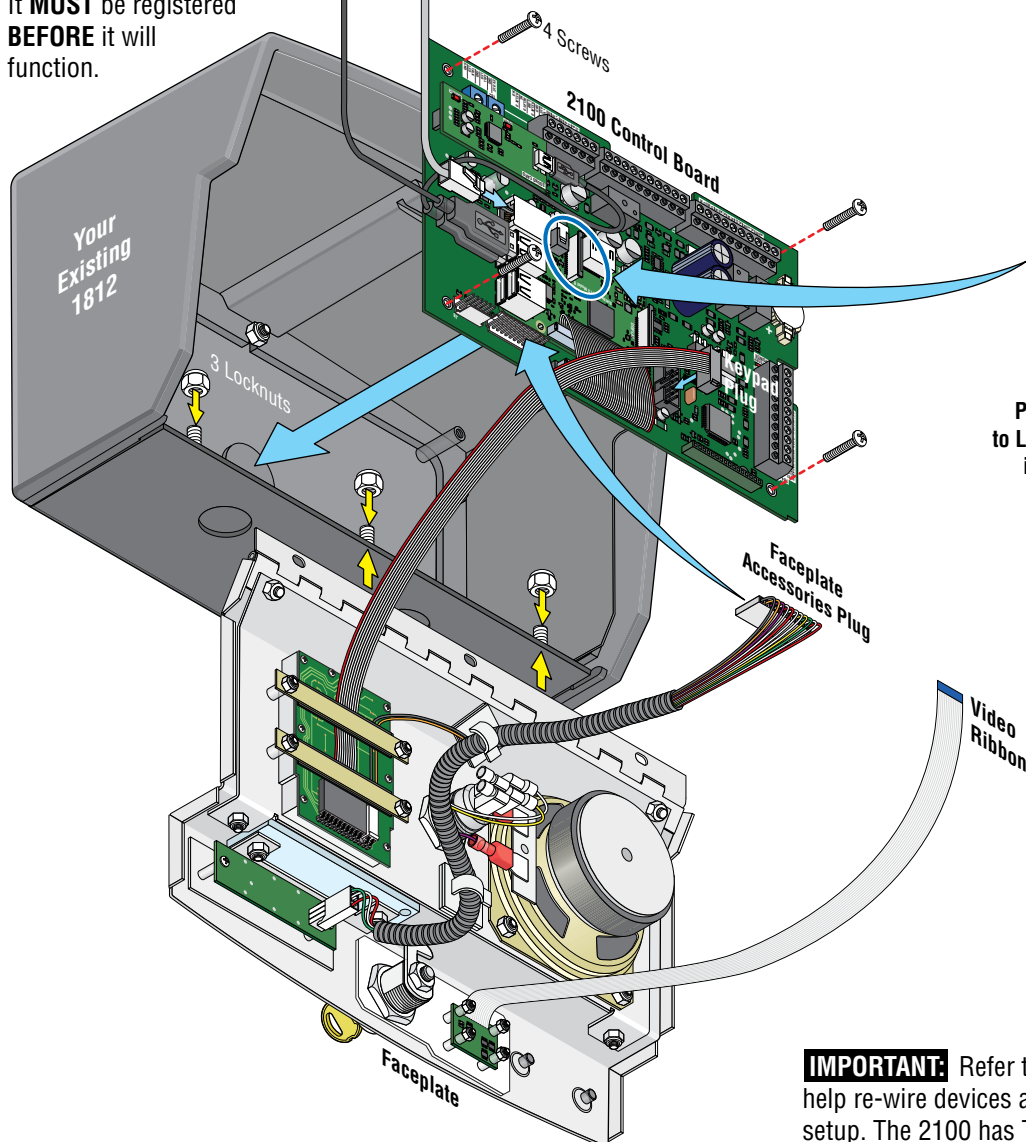

Video Ribbon Connection Detail

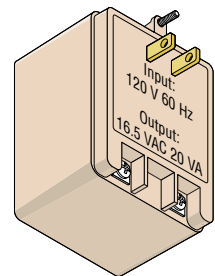
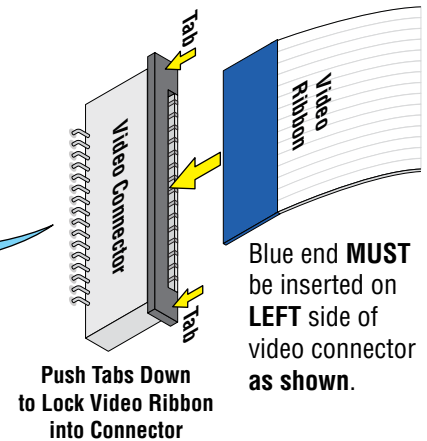

Replace the old 1812 power plug-in transformer with the new one included in this kit.

IMPORTANT: Refer to the **2100 Series Entry manual** to help re-wire devices and programming for **your specific** setup. The 2100 has Three (3) type C relays, **1A max**.