

REVERSE DIRECTION OF FOLDING ARM BRACKET KIT

DoorKing Part Number

1601-545

This kit is designed for the **1601 barrier gate operator, 1603 auto-spikes and 1620 lane barrier ONLY**. It **CANNOT** be used on a 1602 or the 1625 wedge barrier. It **REVERSES** the **HORIZONTAL arm Direction** from the factory setup for **ANY style** folding arm.

See 1601/1602 Installation/Owners manual (1601-065 PDF) for Operator installation “Limitations” and to “Reverse Horizontal Arm Direction Procedure” to change the magnetic limit assemblies from the factory setup (**REQUIRED**).

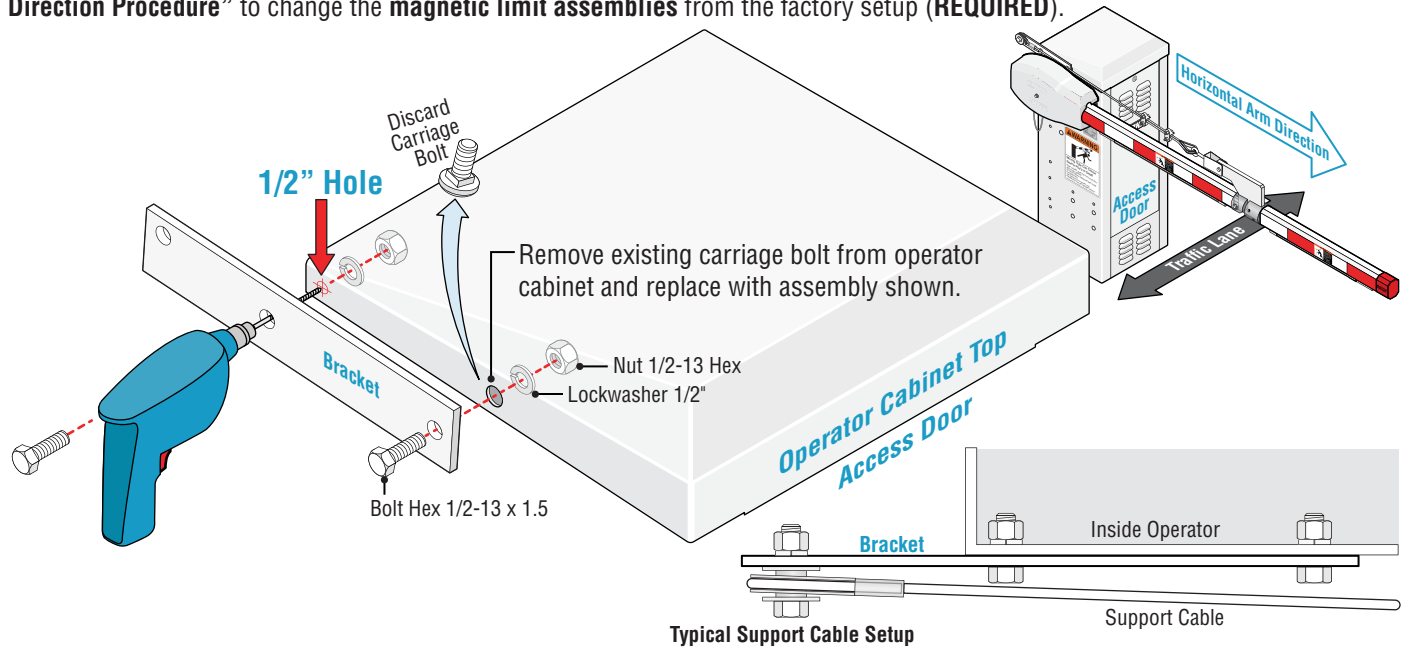

FIRST remove carriage bolt indicated from operator cabinet top.

THEN use that **EXISTING** hole in cabinet to **install bracket** as shown with the supplied 1/2" x 1 1/2" bolt, lockwasher and nut.

NEXT **center** the **SECOND** bracket hole on operator cabinet top (depending on which model you have) and drill a **1/2" hole** into cabinet and secure with the supplied 1/2" x 1 1/2" bolt, lockwasher and nut.

FINALLY . . . attach the folding arm's support cable as shown (depending on which style folding arm you have).

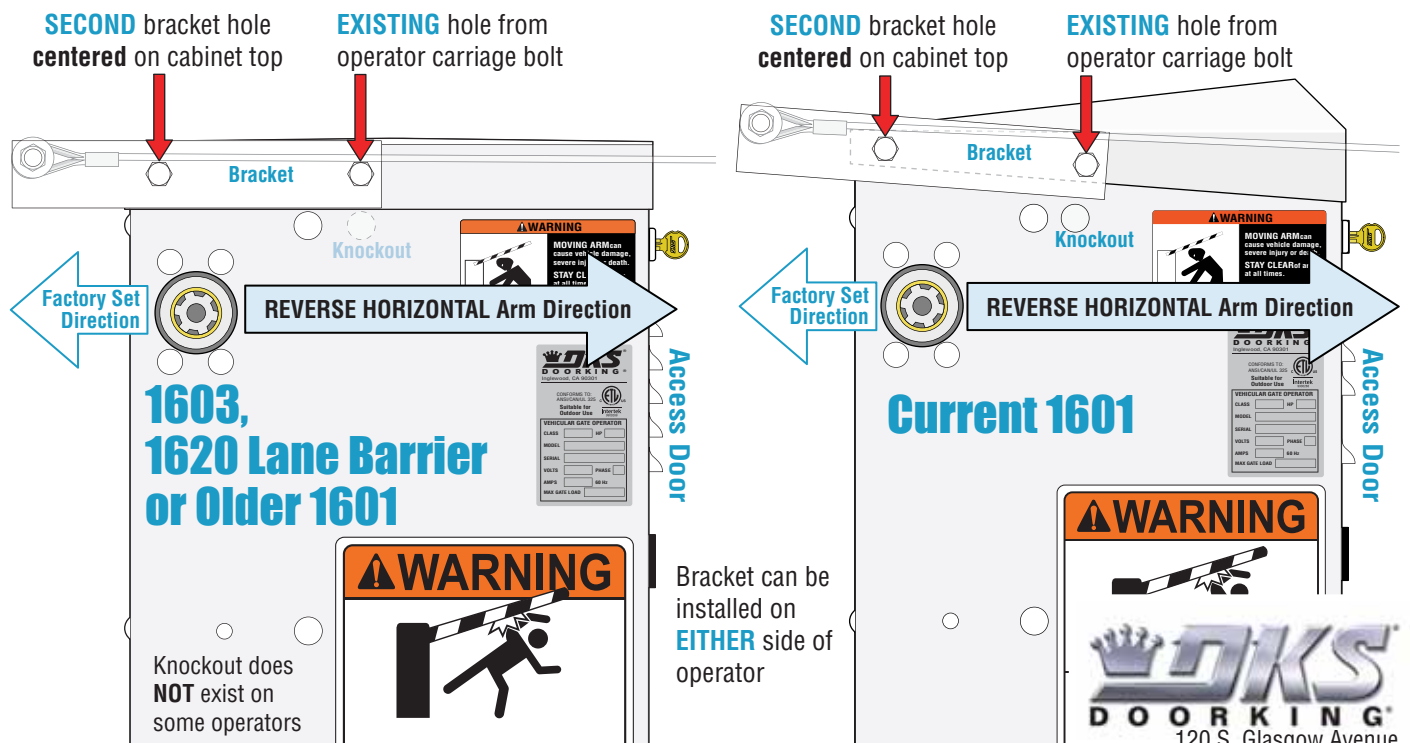

Bracket can be installed on **EITHER** side of operator