

QUICKSTART "BASIC" GUIDELINES FOR MODEL 6500 - FOR GATES UP TO 18 FEET AND OPENING 90°

UL 325 August
2018 Standard



120 S. Glasgow Avenue
Inglewood, California 90301
U.S.A.

Model 6500 is intended for installation only on swing gates used for vehicles. Pedestrians must be supplied with a separate access opening.

For safety and installation instructions, please refer to the Installation/Owner's manual.

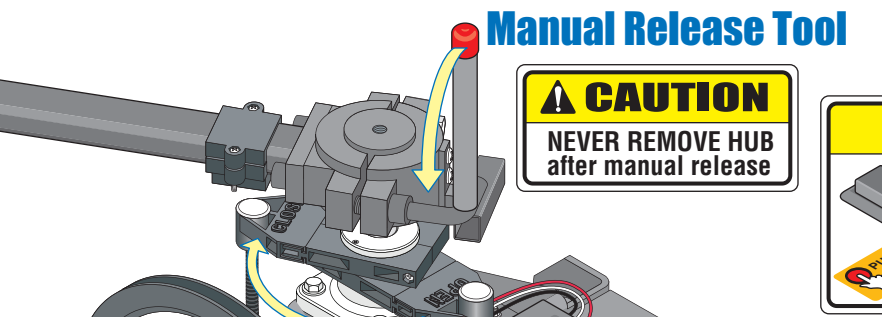
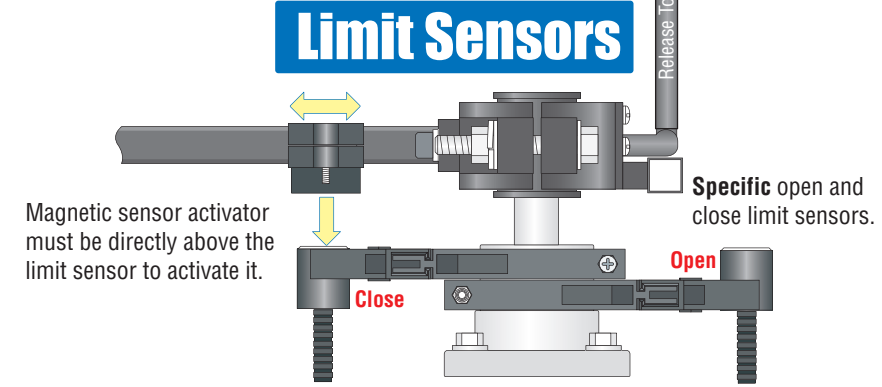
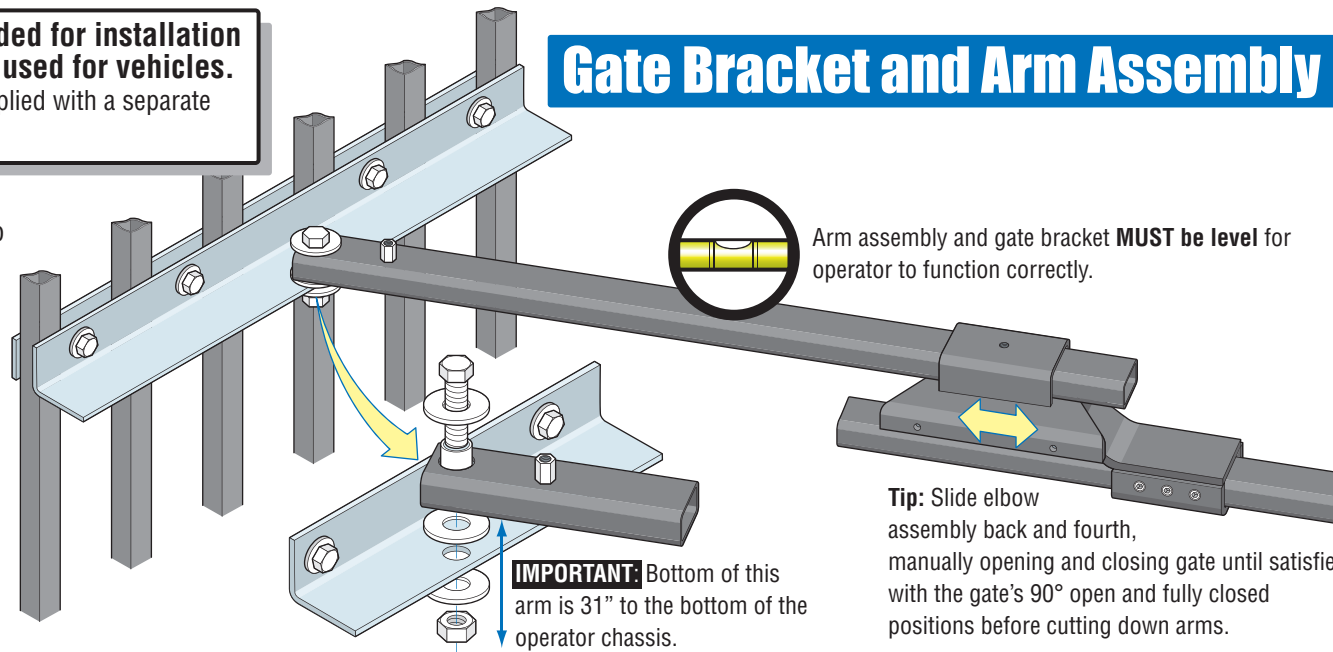

Entrapment Protection must be provided for the gate system where the risk of entrapment or obstruction exists. The operator will not run without one or more monitored type B1 or B2 entrapment protection devices in EACH entrapment area.

Typical Installation Layout

Please refer to the Installation/Owner's manual for Longer or Shorter dimensional layouts.

46" Gate Attachment Point - Gates up to 18 Ft.

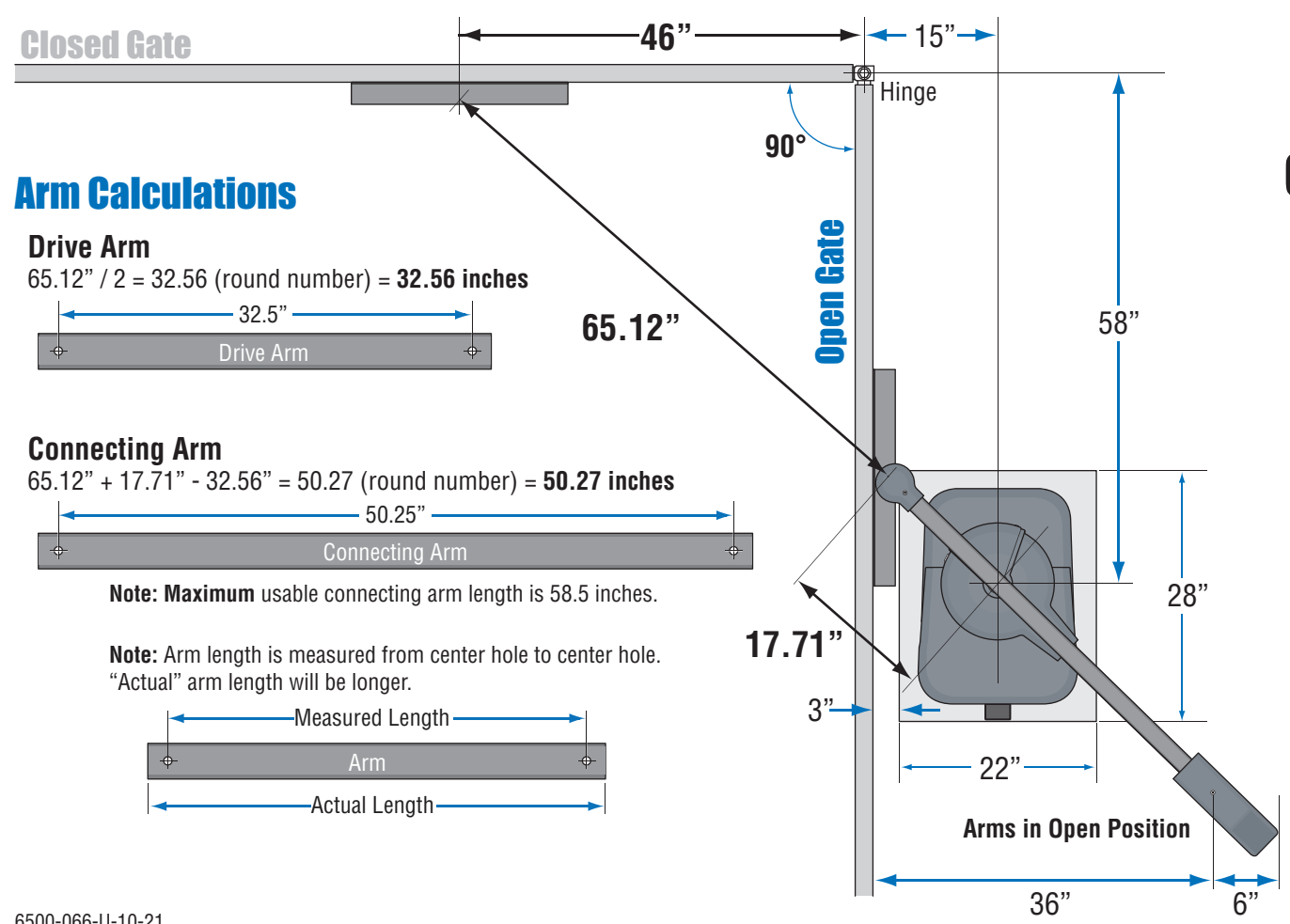

Concrete Pad
Concrete pad **MUST be level**.
Tip: Bevel the edges of concrete pad to eliminate water puddling under the operator.

Concrete Depth

4" minimum above ground.

This depth of the concrete pad is determined by soil conditions and local building codes (reinforced concrete recommended).

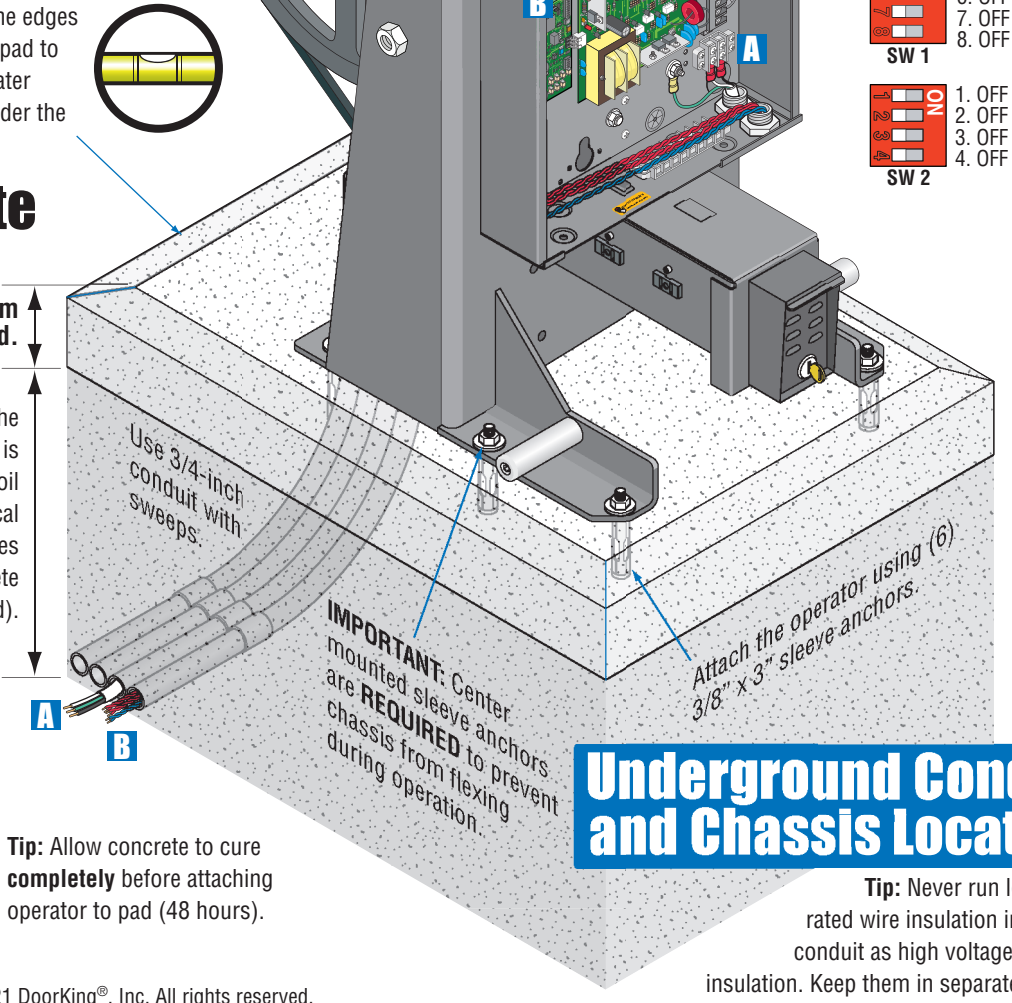

DIP-Switches

- SW 1**
1. ON
 2. OFF
 3. OFF
 4. ON → Auto Close Timer
 5. OFF
 6. OFF
 7. OFF
 8. OFF
- SW 2**
1. OFF
 2. OFF
 3. OFF
 4. OFF
- Adjust 1 to 23 sec.**

AC Power Connection

OPERATOR MUST BE PROPERLY GROUNDED!!
Tip: It is recommended that a surge suppressor be installed on the high voltage power lines.

DANGER
HIGH VOLTAGE!

CAUTION
Limit sensors **MUST** be in position **BEFORE** cycling operator the first time.

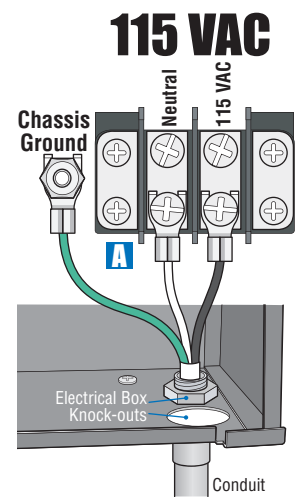

Note: "Optional" High Voltage Kit black and white wires connect the same as shown. See High Voltage Kit instruction sheet for more information.

Loop Detectors

B Not included - Refer to the Installation/Owner's manual and Loop Information Manual (available **FREE** from www.doorking.com) for more information on loops and loop detectors.

Radio Receiver

C Not included - Refer to a specific Radio Receiver Manual (available from www.doorking.com) for more information on radio receivers and antenna installation. (See reverse side for wiring)

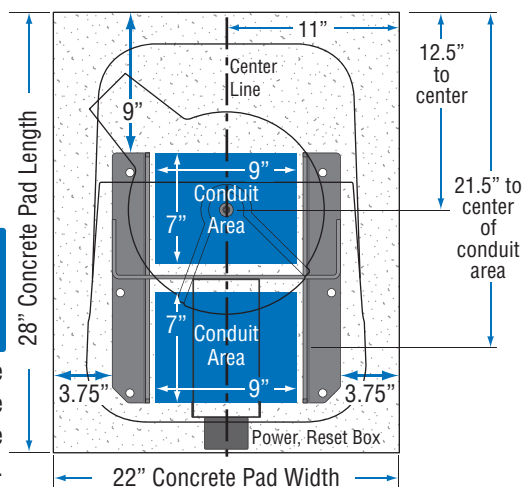

Tip: Never run low voltage rated wire insulation in the same conduit as high voltage rated wire insulation. Keep them in separate conduits.

QUICKSTART "BASIC" GUIDELINES FOR MODEL 6500 - DIP-SWITCH AND WIRING REFERENCE

Model 6500 is intended for installation only on swing gates used for vehicles.
Pedestrians must be supplied with a separate access opening.

For safety and installation instructions, please refer to the Installation/Owner's manual.

SW 1 DIP-Switches

Switch	Function	Setting	Description
1	Primary 6500 Changes Gate Opening Direction	Opens Clockwise	ON
		Opens Counter-Clockwise	OFF
2	Secondary 6500 Changes Gate Opening Direction	Same as above, for secondary 6500 ONLY.	
3	Exit Loop Port Output	OFF	The output wired to terminal #4 becomes the output from the exit loop detector plugged into the EXIT Loop port.
	Full Open Input	ON	Normal Setting. Terminal #4 is a normal full open input.
4	Auto-Close Timer	OFF	Auto-close timer is OFF. Manual input required to close gate.
		ON	Normal Setting. Auto-close timer is ON. Adjustable from 1-23 seconds.
5	Reverses Gate	OFF	Normal Setting. Input to terminal #6 and reverse loop will stop and reverse gate to the full open position during the close cycle ONLY.
	External Shadow Loop Detector	ON	Input to terminal #6 becomes a SHADOW loop input. It is only active when the gate is fully opened. (Shadow loop setting when external loop detector is used)
6	Single Operator	OFF	Normal Setting. Switch must be OFF for single operator.
	Dual Operators	ON	Switch must be ON when primary/secondary (dual) gates are used.
7 and 8	Circuit Board Relay	7-OFF 8-OFF	Normal Setting. Relay activates when gate is at open limit. (Shadow loop setting when DoorKing Plug-In loop detector is used)
		7-OFF 8-ON	Relay activates when gate is not closed.
		7-ON 8-OFF	Relay activates when gate is opening and open.
		7-ON 8-ON	Relay activates during opening and closing cycle.

Note: After a DIP-switch setting is changed, power must be turned OFF and then turned back on for the new setting to take affect.

SW 2 DIP-Switches

Switch	Function	Setting	Description
1	Gate Overlap	OFF	Primary and secondary operators start at the same time (Normal setting for single gate operator).
		ON	The secondary operator will start 1.5 sec. before primary operator during open cycle and the primary operator will start 1.5 sec. before the secondary operator during the close cycle (Normal setting for bi-parting gate operators).
2	Magnetic lock	OFF	Normal Setting. Magnetic lock is not used.
		ON	Magnetic lock is used and connected to terminals 9 and 12.
3		OFF	Normal Setting. Switch 3 MUST be turned OFF for Model 6500 operator.
4		OFF	Normal Setting. Switch 4 MUST be turned OFF for Model 6500 operator.

Fire Dept Open

Gate will **ONLY OPEN** when this device is activated by authorized personnel ONLY (fire, police, EMS) and operator has power. Alarm will sound during entire open cycle. Operator will then go into a hard shutdown once fully opened. Operator **MUST** be reset to function normally again. This device **MUST** be mounted in the line-of-site of gate so authorized personnel can monitor gate movement.

Dual Gate Operators Note: Connect device to **BOTH** operators, both gates will fully open.

Activation Note: Activation of this device will **OPEN** gate regardless of the status of the open direction monitored external entrapment protection device(s). If gate is opening, and the operator's **inherent** entrapment protection system detects an obstruction, the operator will reverse approx. 2 inches and go into a hard shutdown. Operator reset button **MUST** be pushed to function again **OR** cycle operator's power.

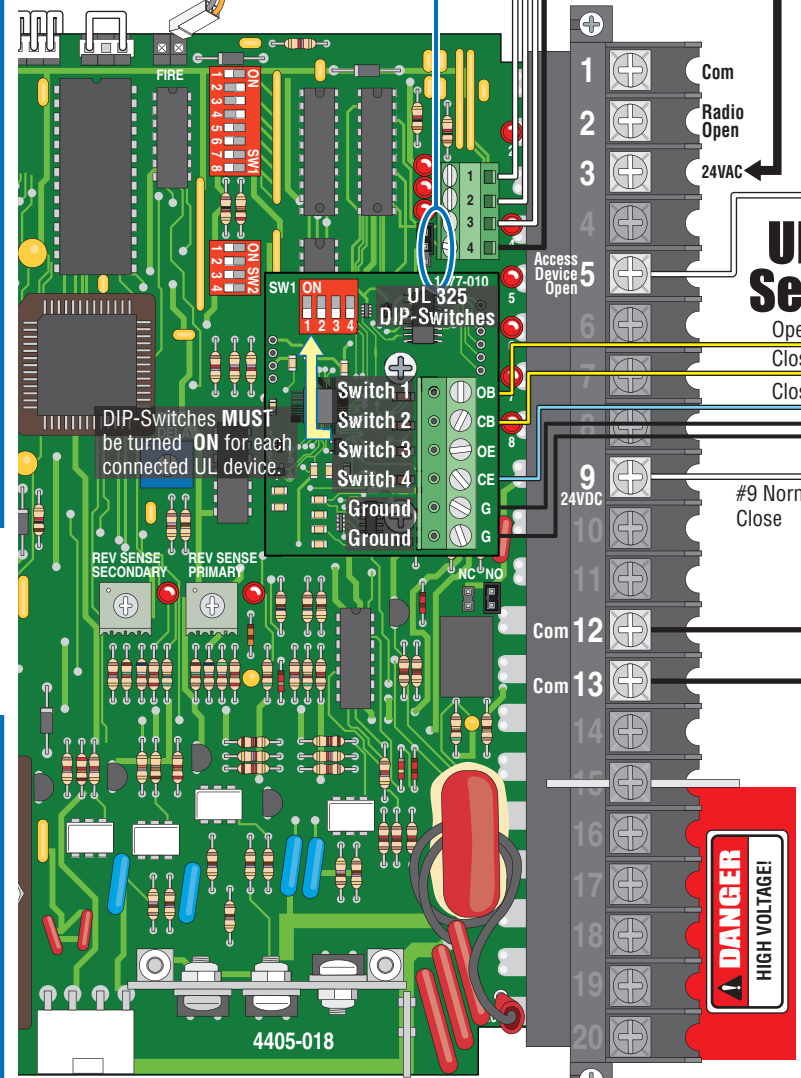
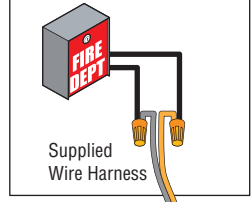

20-Pin Main Terminal



DANGER HIGH VOLTAGE!

24 Volt 1 amp max.

SW 2, switch 2 ON.

Important: Controls intended for user activation must be located at least six (6) feet away from any moving part of the gate and where the user is prevented from reaching over, under, around or through the gate to operate the controls. Emergency access controls only accessible by authorized personnel (e.g., fire, police, EMS) may be placed at any location in the line-of-sight of the gate.

UL 325 August 2018 Standard



120 S. Glasgow Avenue
Inglewood, California 90301
U.S.A.

3-Pin Remote Terminal

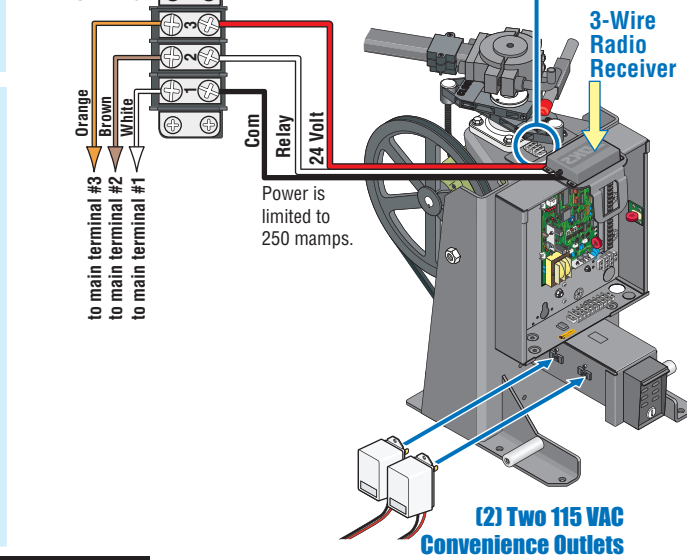

4-Pin Non-Removable Terminal

3-Button Control Station
Use a standard 4-wire 3-button control station. DoorKing's 3-wire 3-button control station CANNOT be used.

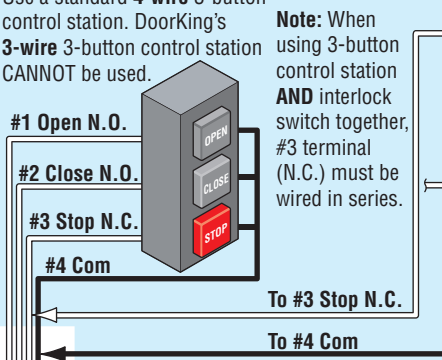

Normally Closed Interlock Switch

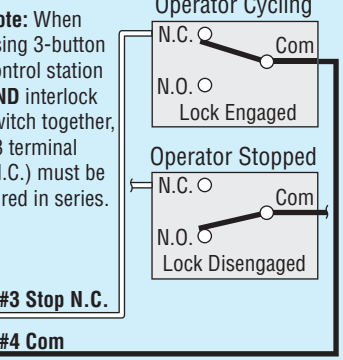

Terminal #3 Note: Exceeding 250 mA of power from this terminal may cause the circuit board transformer to overheat, causing intermittent problems.

IMPORTANT: Monitored Photo and Edge sensors must be end-of-line resistive types. See specific manufacturer's wiring manual for more information.

UL 325 Sensors

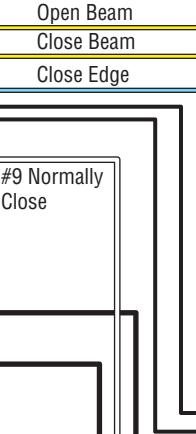

External Entrapment Protection Devices

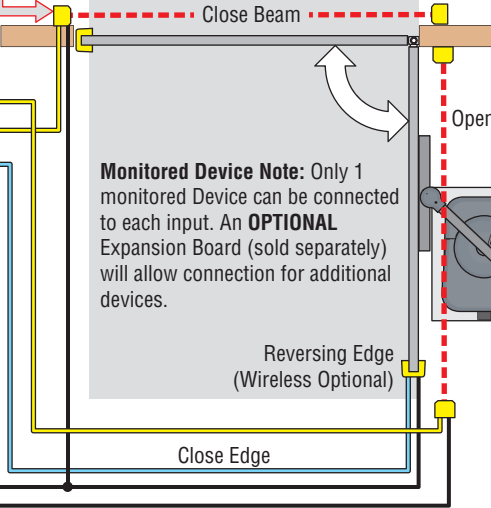

Edge Inputs (OE Switch 3 & CE Switch 4) Note: Open and Close Edge inputs will activate in **EITHER** direction of gate travel.

Entrapment Protection must be provided for the gate system where the risk of entrapment or obstruction exists. The operator will not run without one or more monitored type B1 or B2 entrapment protection devices in EACH entrapment area.

Magnetic Lock

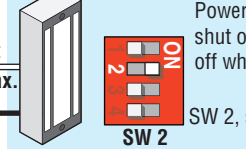

Power (24-Volt DC) and logic output. Power is shut off .5 sec. prior to gate starting and remains off while gate is opening and in the open position.

Type of wiring to be used on ALL external devices:
A) Type CL2, CL2P, CL2R, or CL2X.
B) Other cable with equivalent or better electrical, mechanical, and flammability ratings.

#5 - Access Control Devices

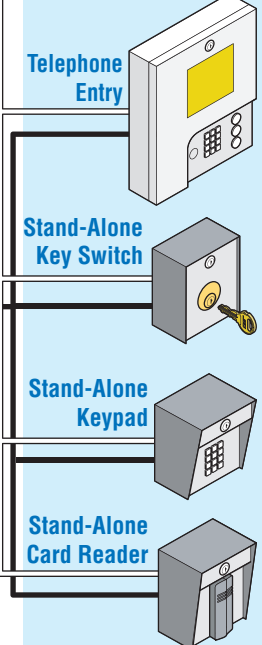

Note: All stand-alone and telephone entry devices must use a separate power source.