

LED TRAFFIC LIGHT AND MOUNTING KITS

DoorKing Part Numbers

1603-221

6 Ft Cable/No Post

1603-222

6 Ft Cable/35" Post

1603-223

11 Ft Cable/95" Post

These kits are designed for the 1600 model barrier gate operators. Recommended for the 1603 auto spike system. The traffic signal is synchronized with the gate operator's up/down cycle. The red LED light stays on and only changes to the green LED when the operator's arm is fully raised.

Kits Include:

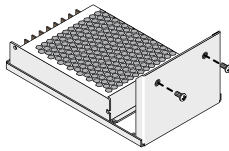

12 VDC Power Supply, Mounting Bracket with Mounting Screws and Labeled Wires



6 or 11 Ft Traffic Light Cable

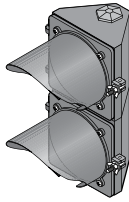

Traffic Light Assembly

Support Post Hardware:

Kit P/Ns 1603-222 & 1603-223 ONLY

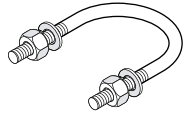

U-Bolt Clamp with lockwashers and nuts (2 sets)



3/4" Conduit Nipple and Conduit Nut



5/8" Cover Bracket bolt and lockwasher (2 sets)

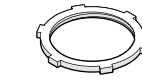

2" Conduit Nut (3)

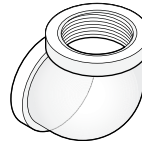

2" Threaded Elbow

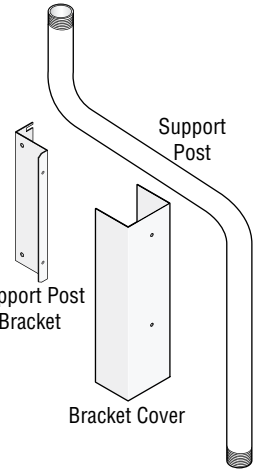

Support Post

Support Post Bracket

Bracket Cover

DOs and DON'Ts

Different Model Installations

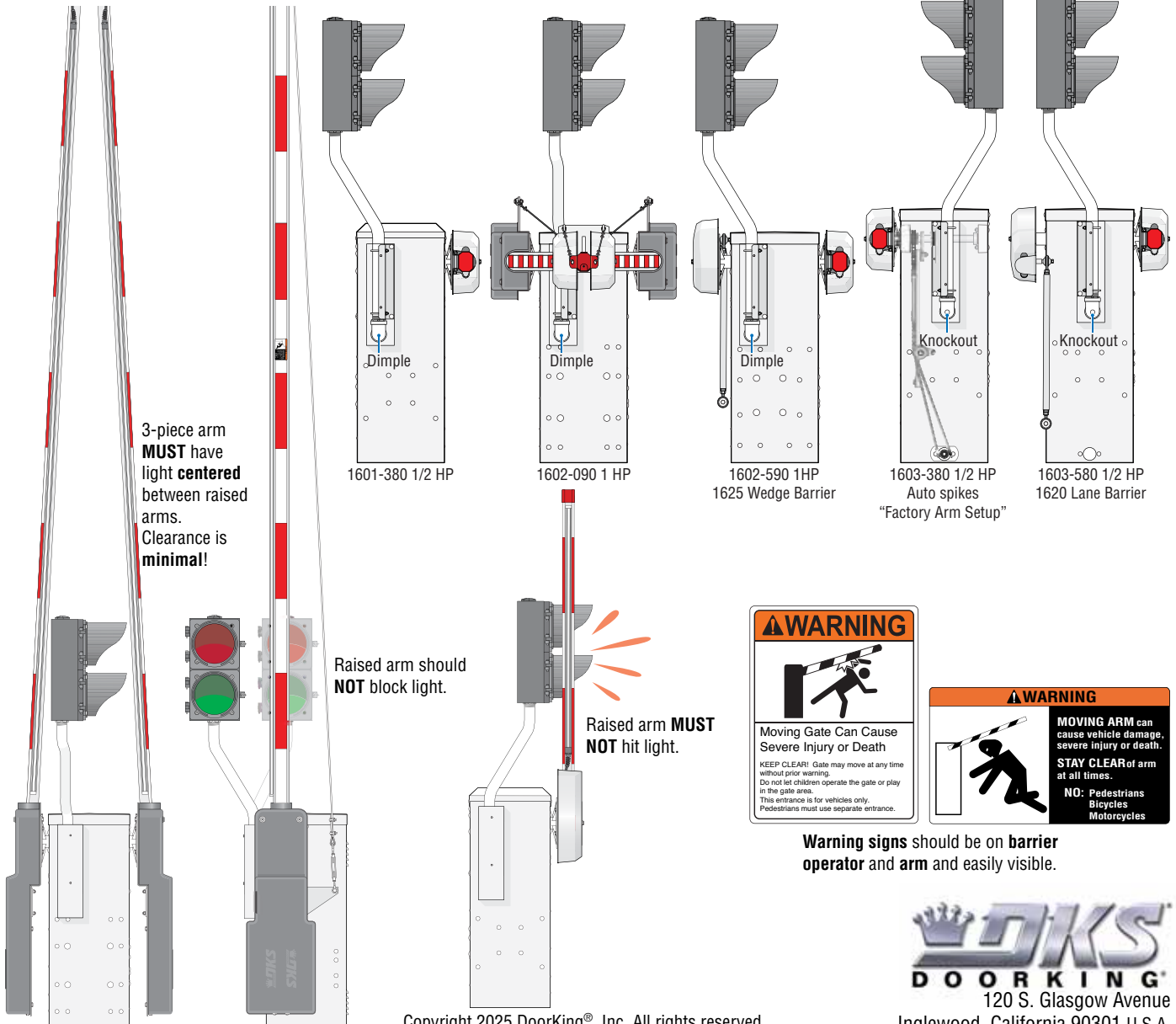

3-piece arm **MUST** have light **centered** between raised arms. Clearance is **minimal!**

Raised arm should **NOT** block light.

Raised arm **MUST NOT** hit light.

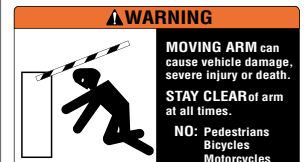

Warning signs should be on barrier operator and arm and easily visible.



120 S. Glasgow Avenue
Inglewood, California 90301 U.S.A.

Copyright 2025 DoorKing®, Inc. All rights reserved.

Mount Power Supply - 12.5 Amps

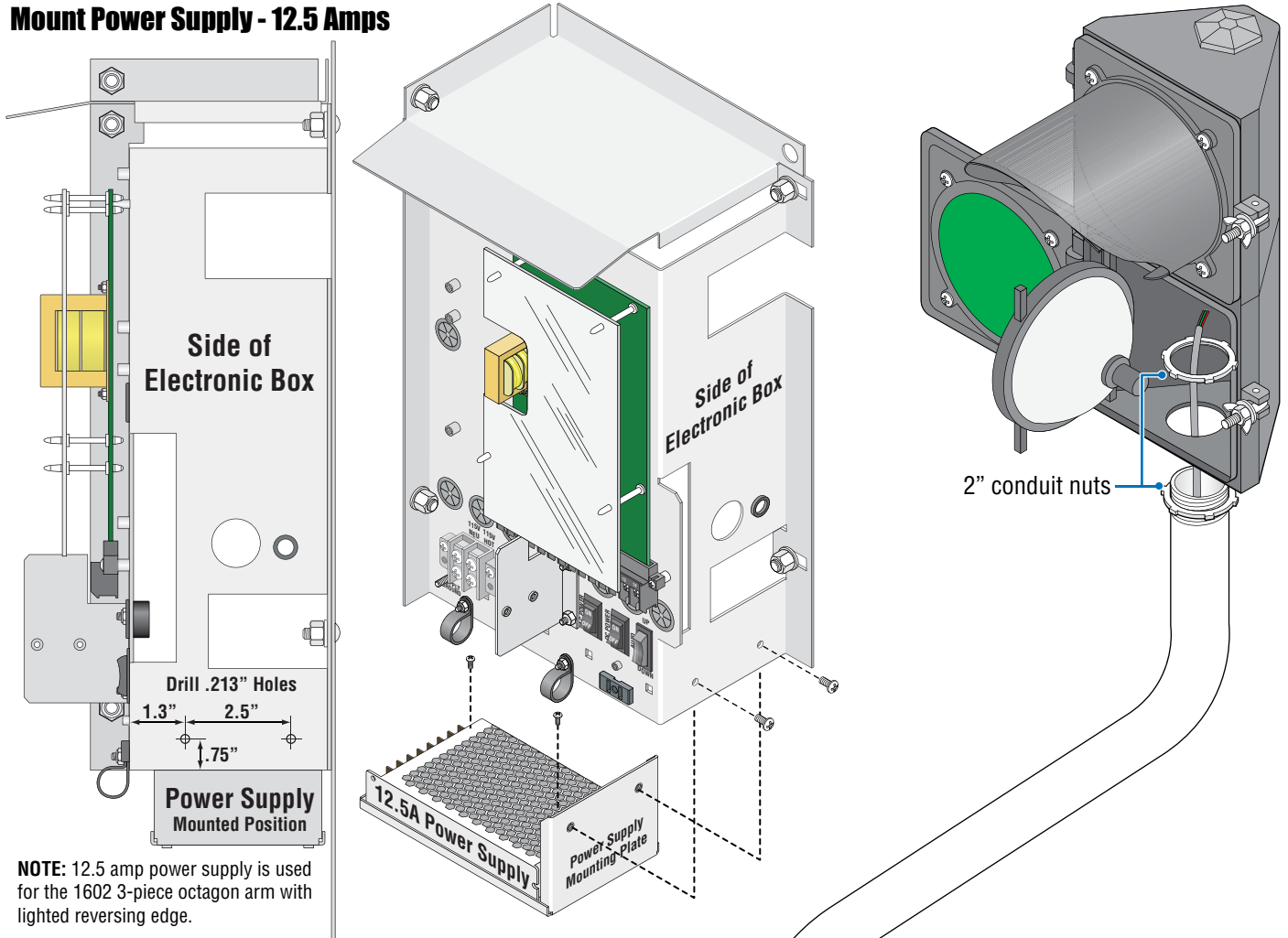

IMPORTANT: Power supply **MUST** be wired **BEFORE** mounting it as shown. See page 4.

Mount Traffic Light to 1601, 1602 or 1625 Wedge Barrier Models "Dimple" Installation

Post on **LEFT** side of bracket.

The "Dimple" is located 3" down and 2" to the **LEFT** of the bottom carriage bolt. It allows the 7/8" drill bit to start the hole in the correct position. Elbow should be **centered** on hole after inserting conduit nipple and running cable through it.

TIP: Make sure all metal shavings from the drilling don't get into **ANY** of the electronic components which could cause the operator to malfunction.

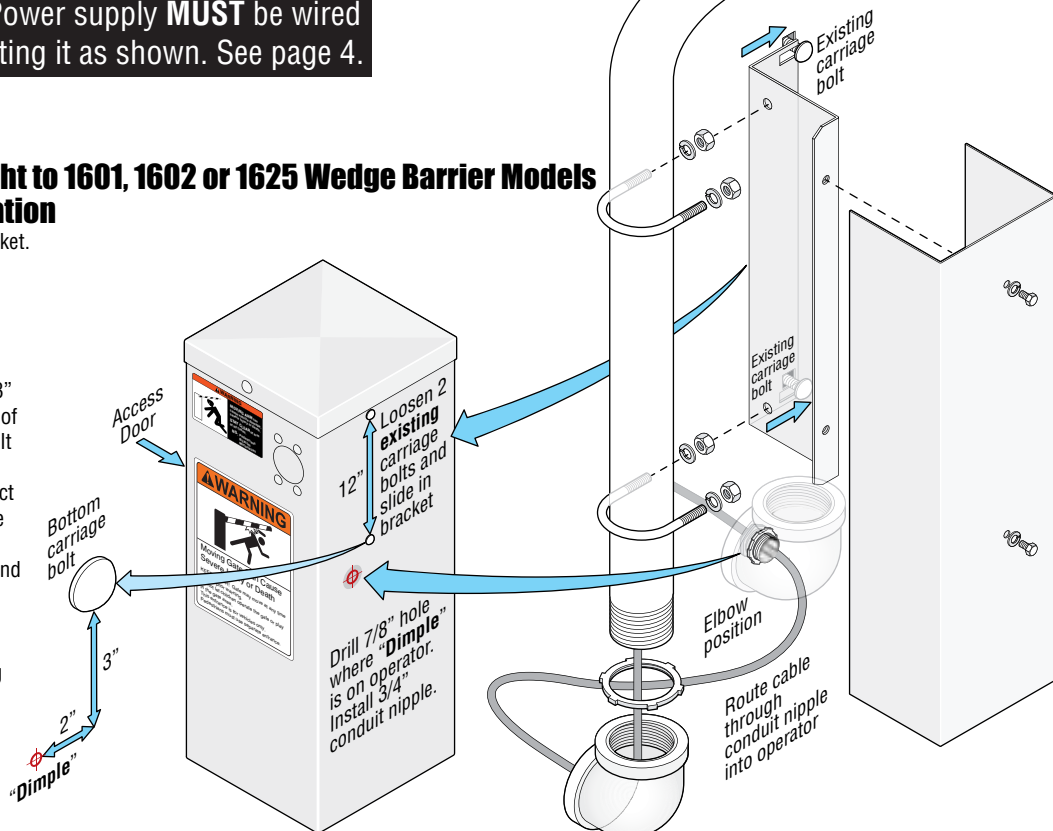

Mount Power Supply - 8.5 Amps

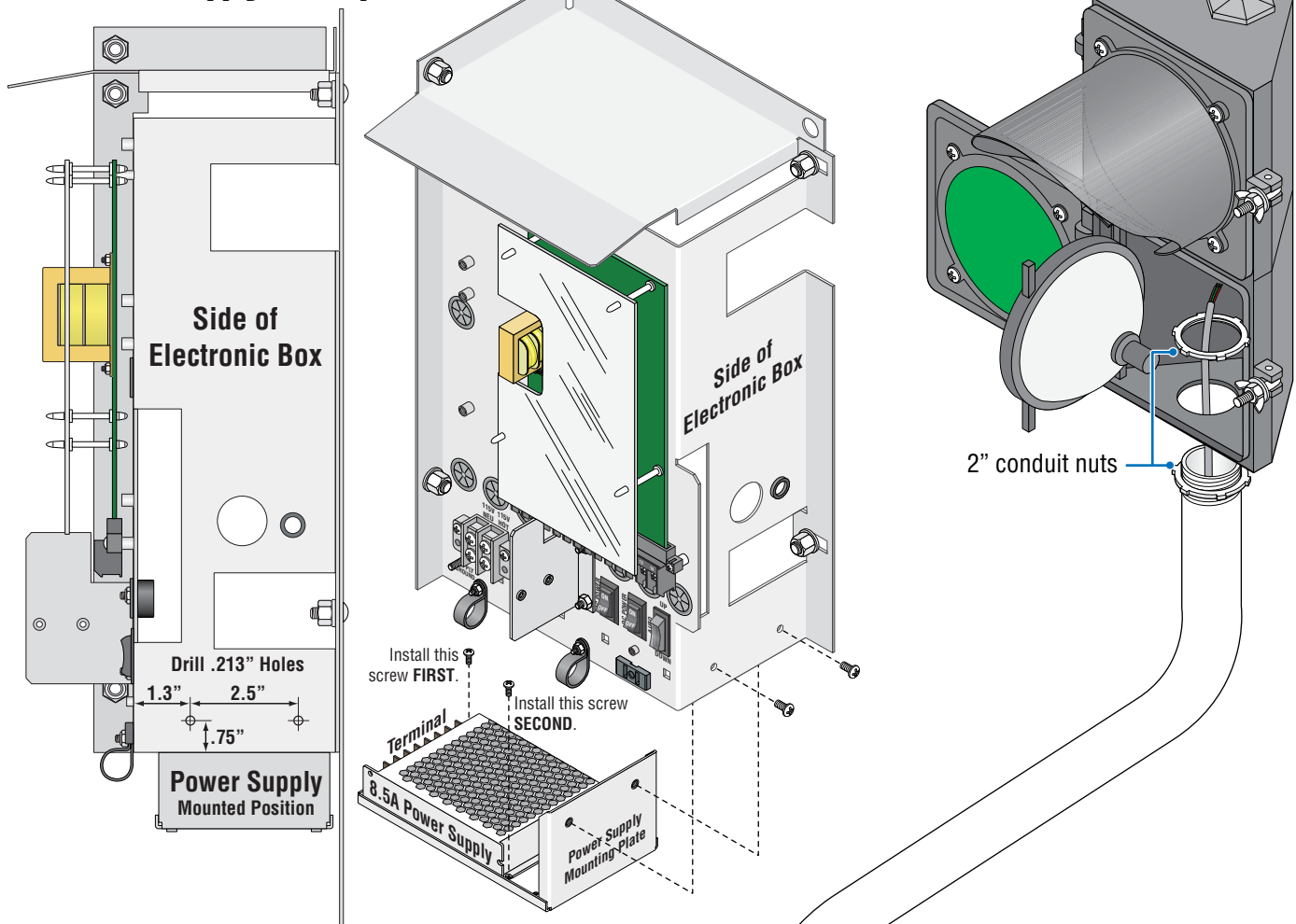

IMPORTANT: Power supply **MUST** be wired **BEFORE** mounting it as shown. See next page.

Mount Traffic Light to 1603 or 1620 Lane Barrier Models "Knockout" Installation

Post on **RIGHT** side of bracket.

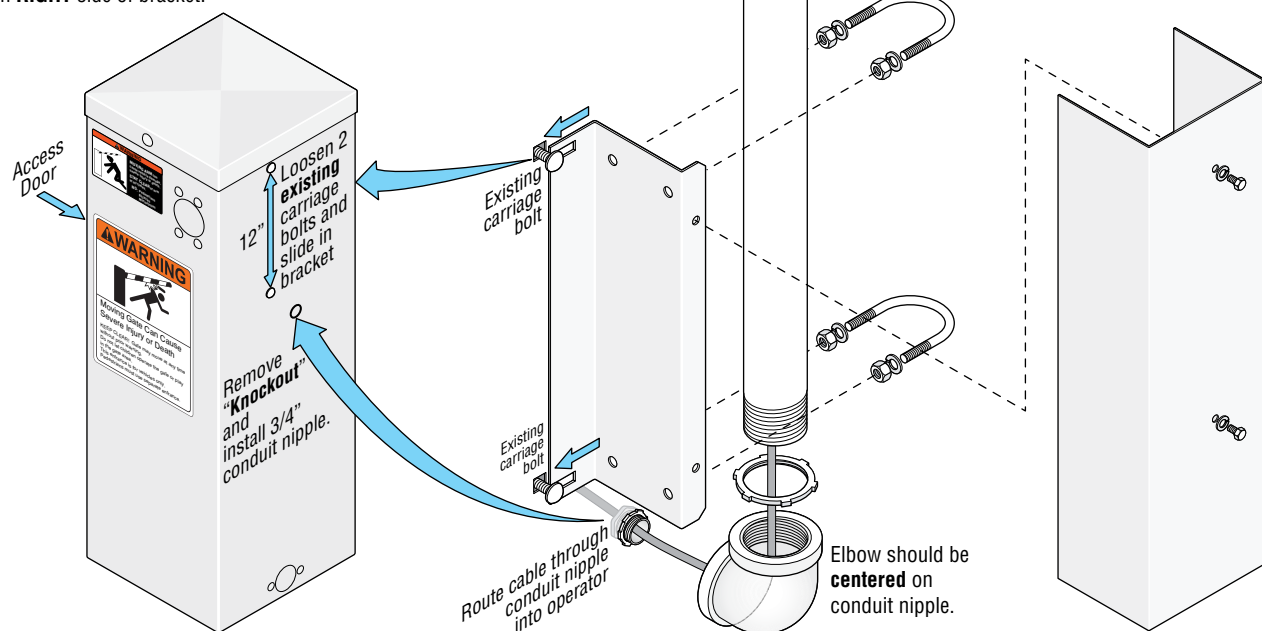

Wire LED Traffic Light to Operator

**⚠ Shut off ALL power to operator BEFORE wiring.
Turn off DC power switch on certain models.**

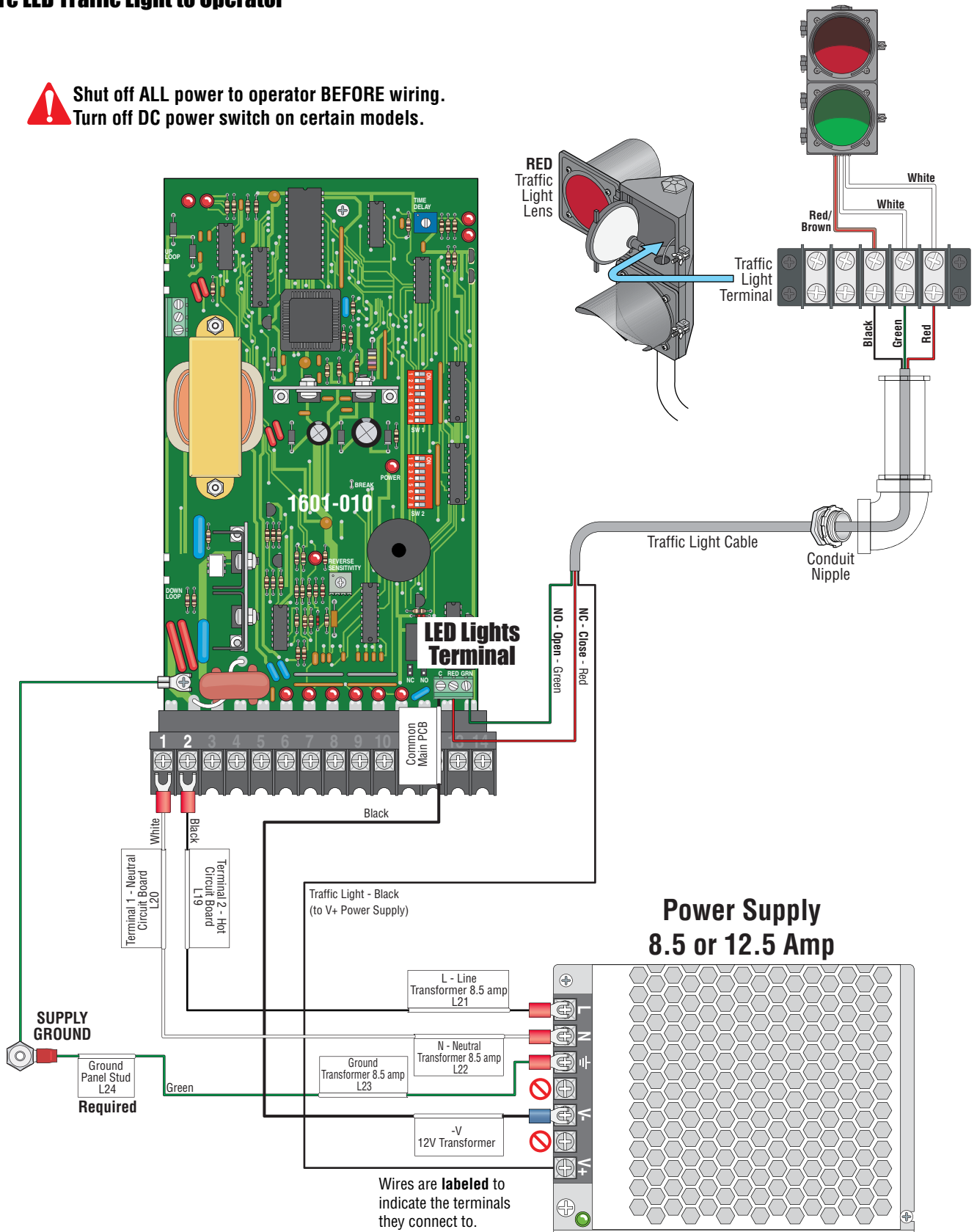

⚠ Keep wires clear of all moving parts.