

# DK Prox CARD READERS INSTALLATION

DoorKing Part Numbers

**1815-300**

mullion style card reader

**1815-301**

single-gang style card reader

**1815-302**

small card reader

DoorKing's DK Prox Card Readers are designed to manage an access point using 26-Bit Wiegand communication. It uses DK Prox proprietary software. Maximum read range varies depending on the model. The readers are sealed in epoxy, making them vandal-resistant and are ideal for both indoor and outdoor applications.

**Access Control Levels:**

Endurance	Level IV
Line Security	Level I
Standby Power	Level I
Attack	Level I
Single Point Locking Device with Keylocks	Level I

## Installation

To achieve optimal performance from the DK Prox card readers, do not mount the reader on metal surfaces. Mounting these readers on a metal surface will decrease the read range of the device. These readers require 0.2 Amp at 12 Volt DC input power. If power is supplied by a plug-in transformer, be sure the output is rated as required and that the transformer is U.L. Listed. LED (yellow wire) and Beeper (blue wire) are activated by ground. **DO NOT** connect these to 12 VDC.

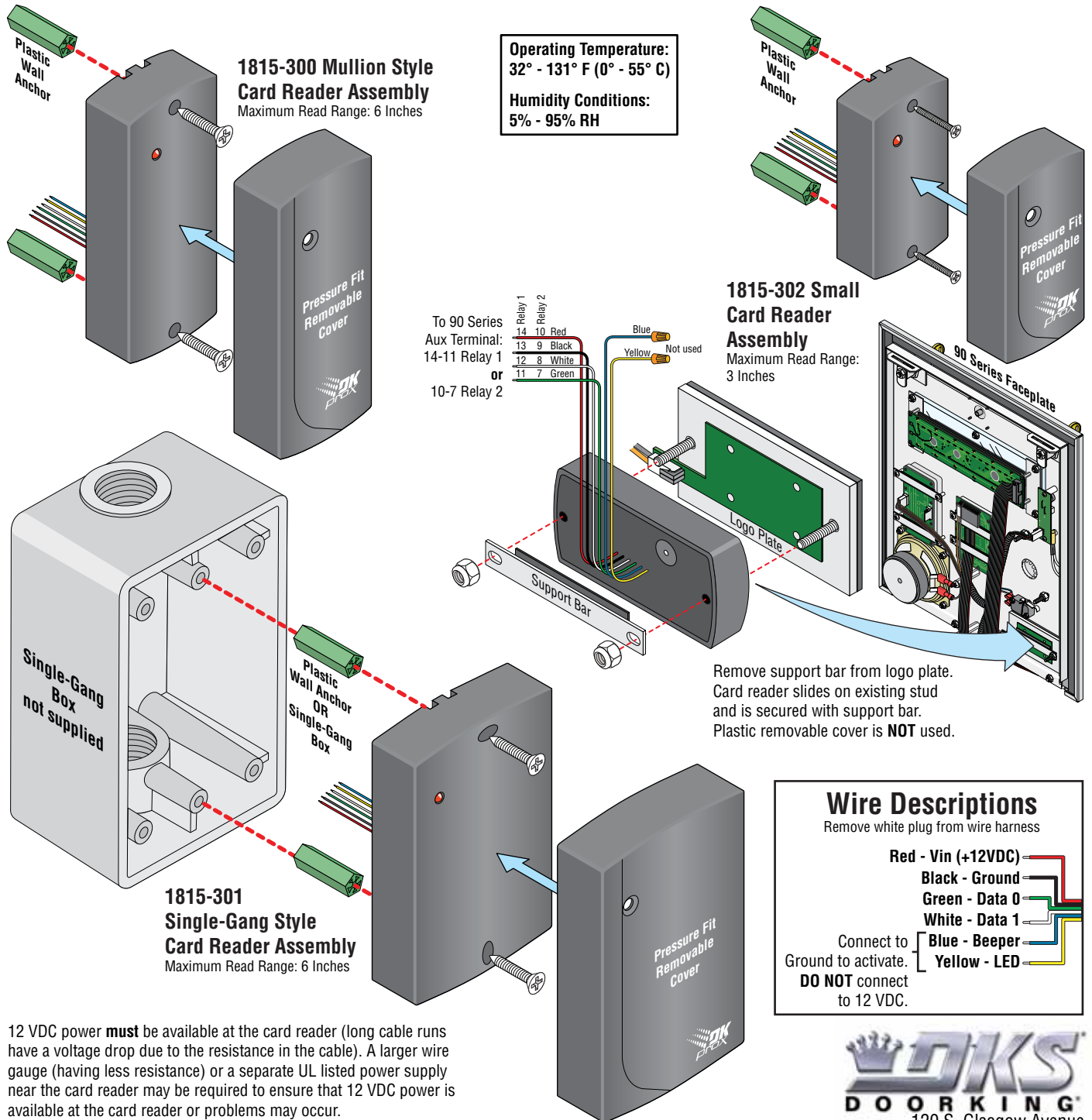

12 VDC power **must** be available at the card reader (long cable runs have a voltage drop due to the resistance in the cable). A larger wire gauge (having less resistance) or a separate UL listed power supply near the card reader may be required to ensure that 12 VDC power is available at the card reader or problems may occur.