

# 9150 Fail-Secure Manual Release Kit

DoorKing Part Number

**2600-865**

Converts a Fail-Safe manual release model 9150 slide gate operator to a Fail-Secure manual release model 9150. Power outages or turning power off **WILL NOT** allow gate to be manually operated without physically unlocking the slide gate operator with the key first. The slide gate operator "Fails" (Loss of AC power) in a "Secure" (Manually in-operable) condition. This option is **typically used in UL 325 Class III and Class IV applications.**

**Kit Includes:** Lock with 2 keys, release bracket with screw, washer and locknut.

## Installation

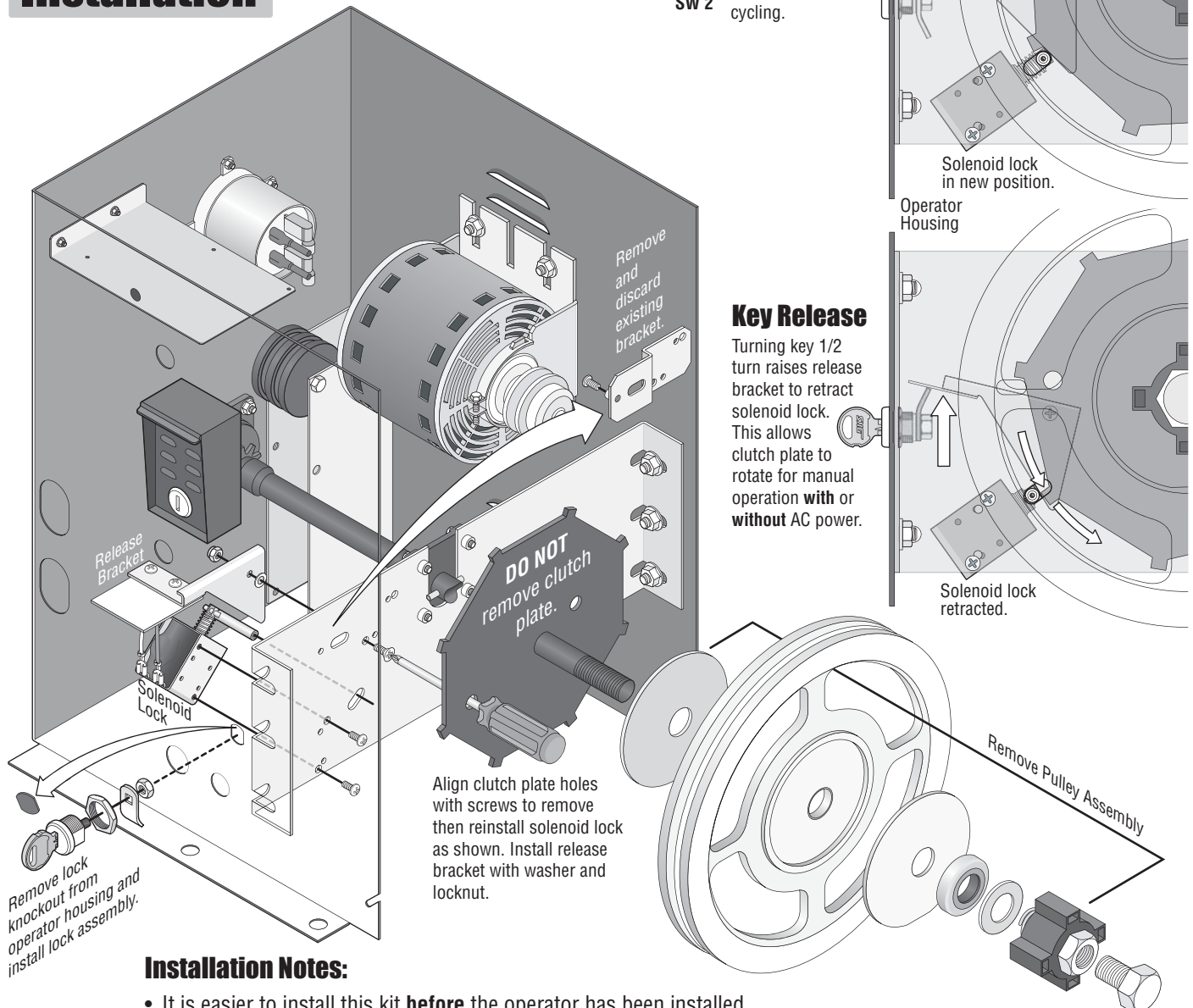

### Installation Notes:

- It is easier to install this kit **before** the operator has been installed.
- Make sure that power to the operator is **OFF** if operator is already operational.
- When reinstalling solenoid lock, existing mounting holes may need to be elongated to allow retracted lock to clear clutch plate stops.