

3-PIECE OCTAGON ARM WITH LED/REVERSE EDGE KIT INSTALL

These LED/Reverse Edge kits are designed **ONLY** for the 1602 model barrier gate operator.

IMPORTANT NOTE: Installation of arms without LED/Reverse Edge kit see pages 7-9.

DoorKing Part Numbers:

1602-282

20 ft Arm Only

AND

1602-982

20 ft LED/Reverse Edge Kit
(Optional for 1602-282 Arm)

1602-284

24 ft Arm Only

AND

1602-984

24 ft LED/Reverse Edge Kit
(Optional for 1602-284 Arm)

1602-287

27 ft Arm Only

AND

1602-987

27 ft LED/Reverse Edge Kit
(Optional for 1602-287 Arm)

Overview of Installation

Prior to beginning the installation of the 3-piece arms **WITH** LED/Reverse edge kit, see pages 1-6. We suggest that you become familiar with the instructions, illustrations, and wiring guide-lines on these pages.

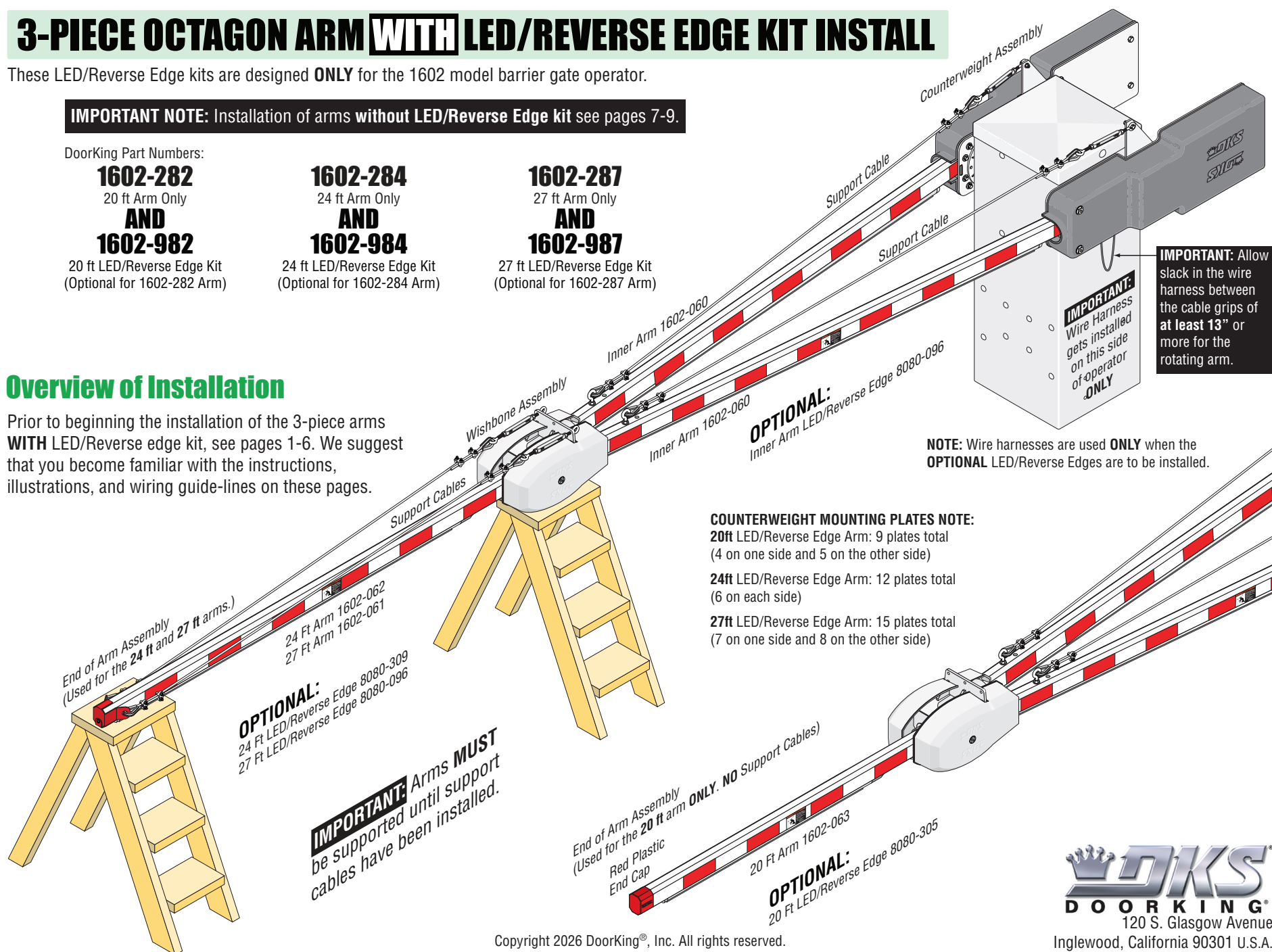

Copyright 2026 DoorKing®, Inc. All rights reserved.

DOOR KING®
120 S. Glasgow Avenue
Inglewood, California 90301 U.S.A.

Counterweight Assembly

Mount hubs on operator **FIRST** Test hubs **UP** and **DOWN** positions **BEFORE** installing counterweight mounting plates, then assemble arms, cables and wire harness on LED/Reverse Edges.

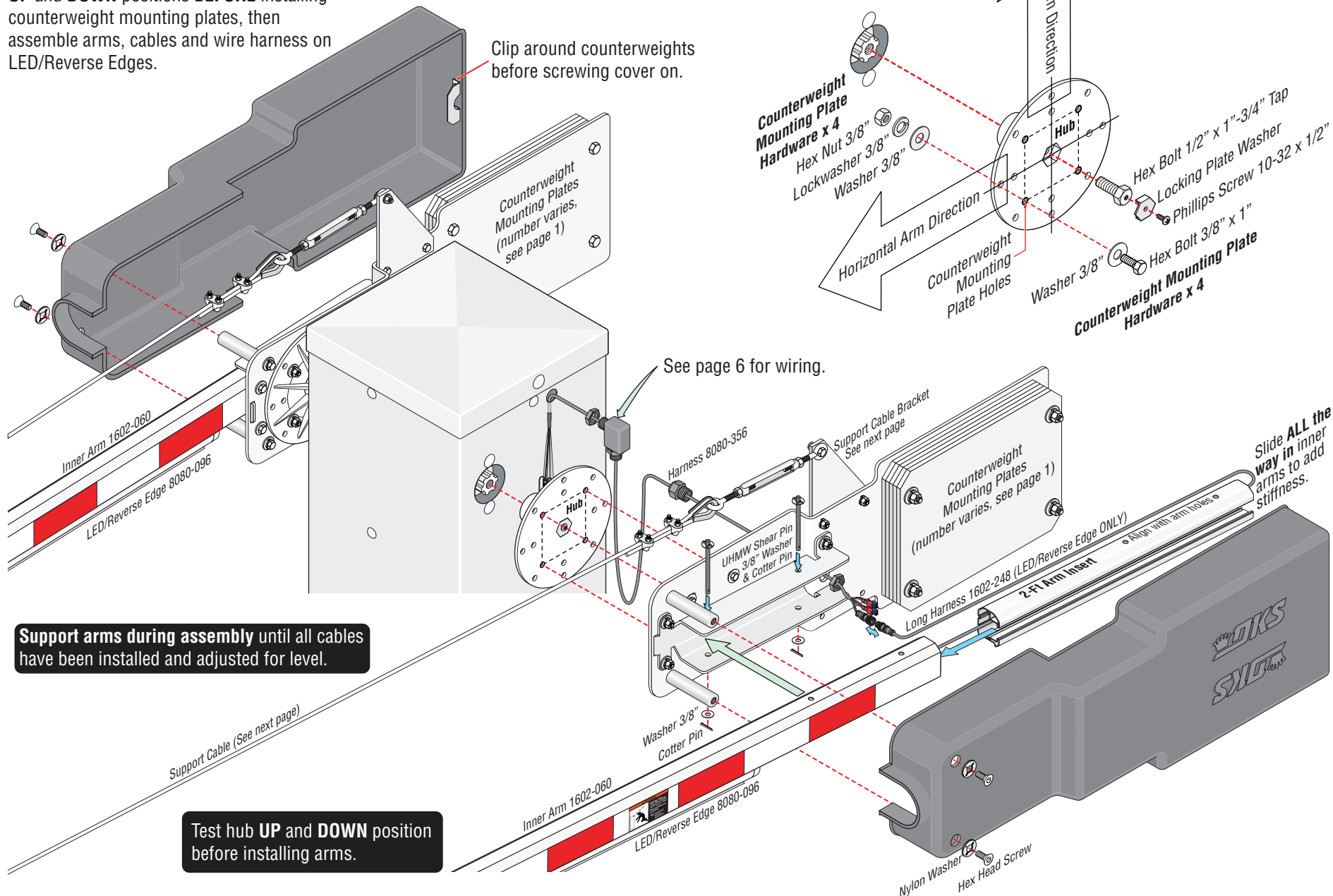

Support Cable Bracket Installation

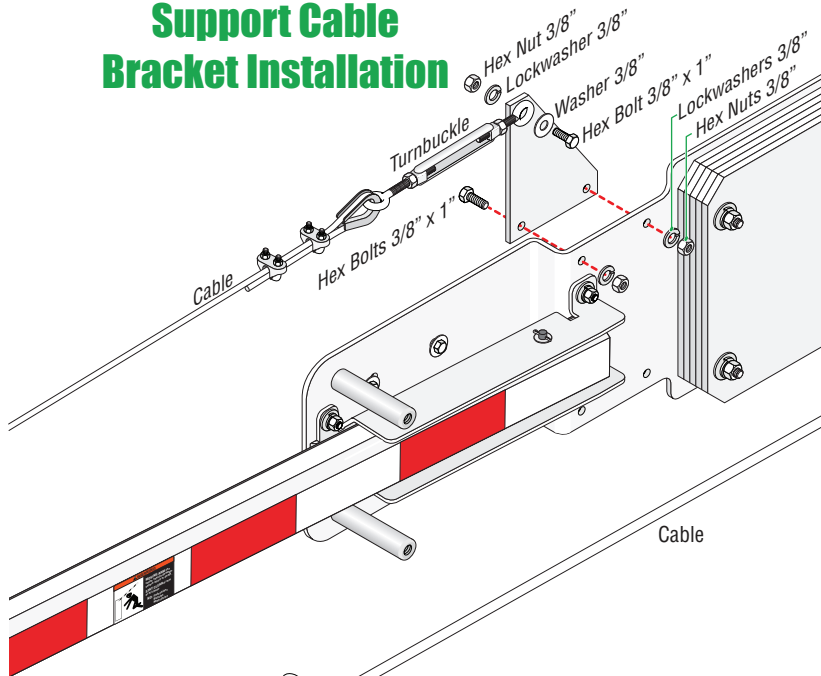

Typical Support Cable Installation

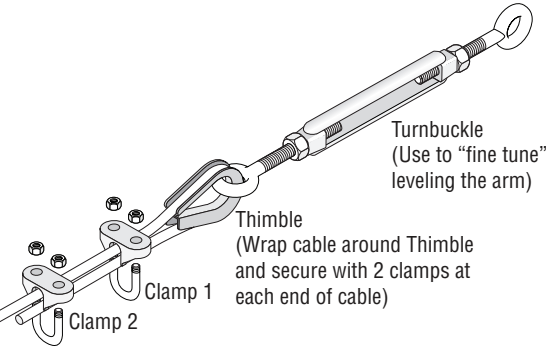

Inner Arms Assembly (Wishbone End)

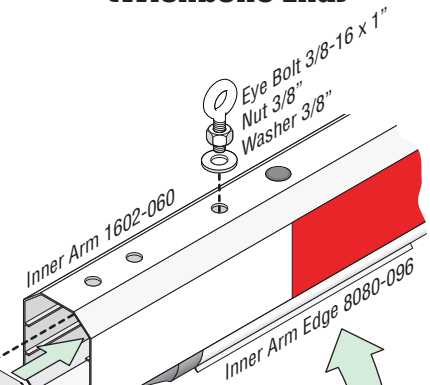

Attaching Turnbuckles to Wishbone 24 & 27 ft arms ONLY.

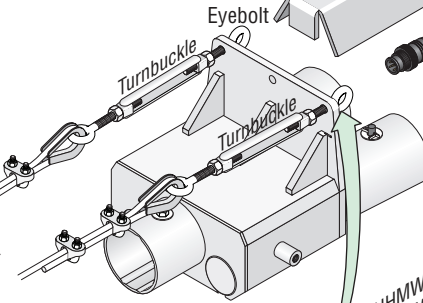

End of Arm Assembly

NOT used for the 20 ft arm.

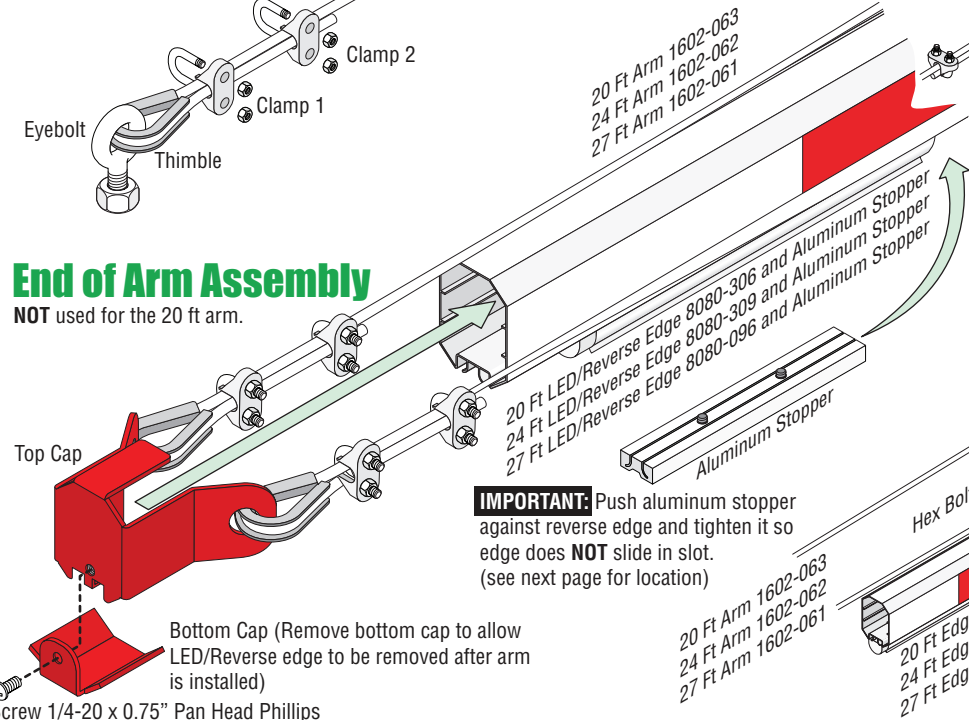

IMPORTANT: Push aluminum stopper against reverse edge and tighten it so edge does **NOT** slide in slot. (see next page for location)

20 Ft Arm 1602-063
24 Ft Arm 1602-062
27 Ft Arm 1602-061

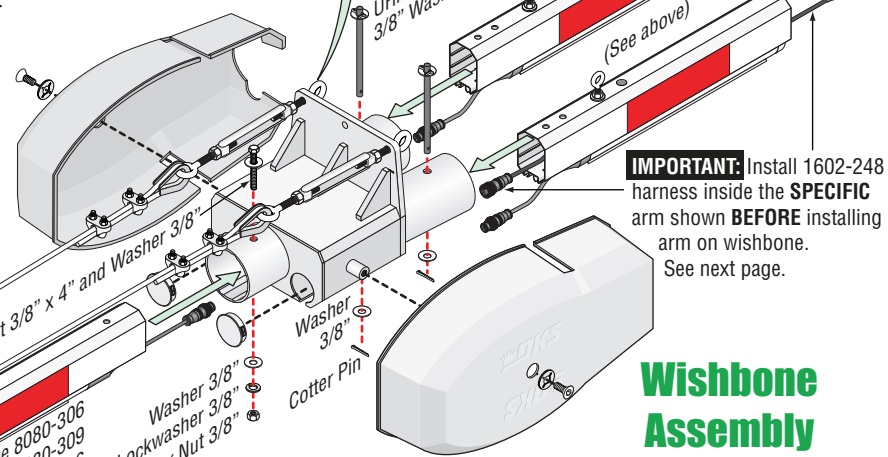

IMPORTANT: Install 1602-248 harness inside the **SPECIFIC** arm shown **BEFORE** installing arm on wishbone. See next page.

Wishbone Assembly

IMPORTANT: Reverse/LED Edges **MUST** be slid in place on arms **BEFORE** installing arms on wishbone. See next page.

LED/Reverse Edge Wiring

Bottom View of Arm

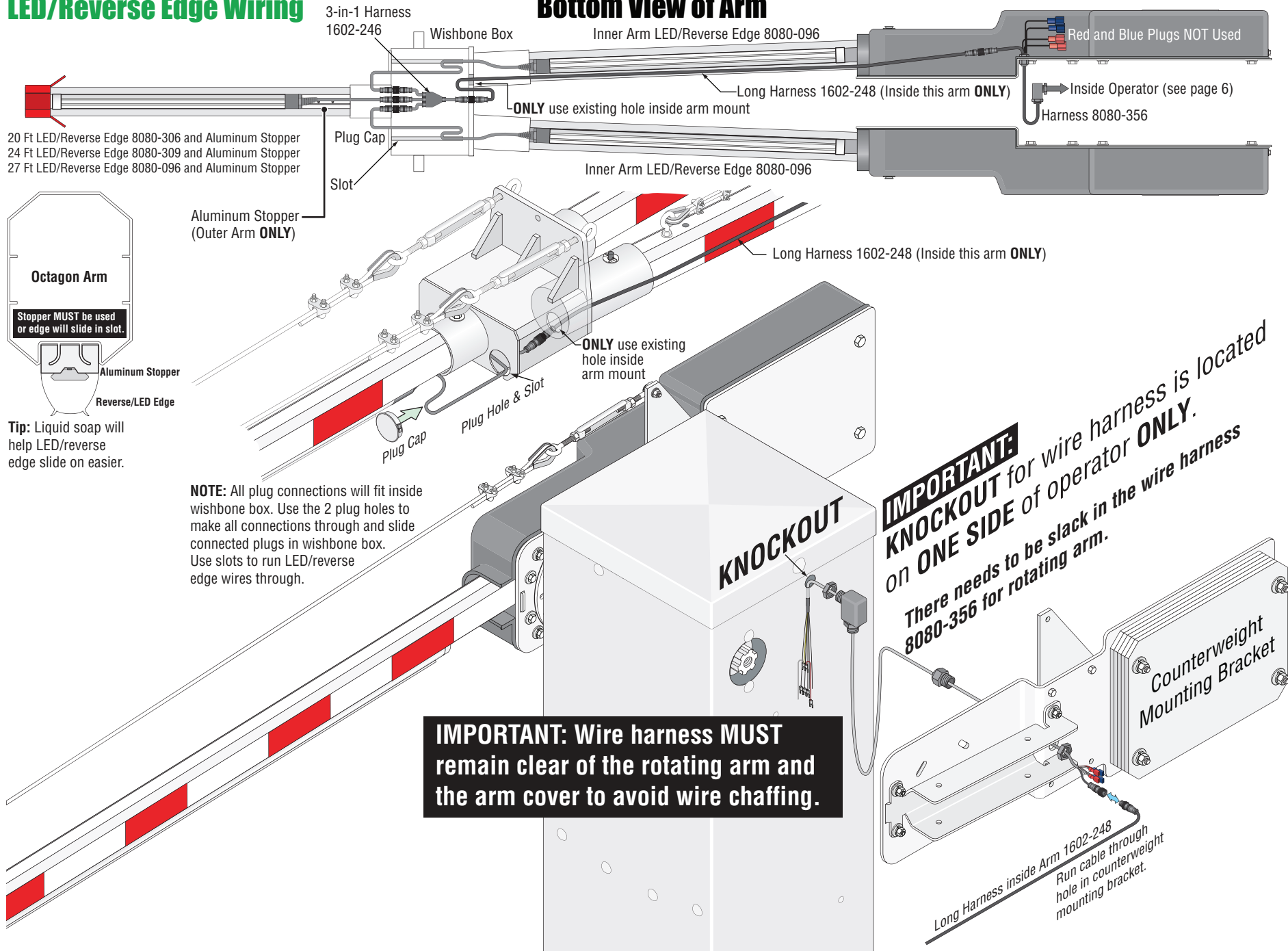

Mount Power Supply

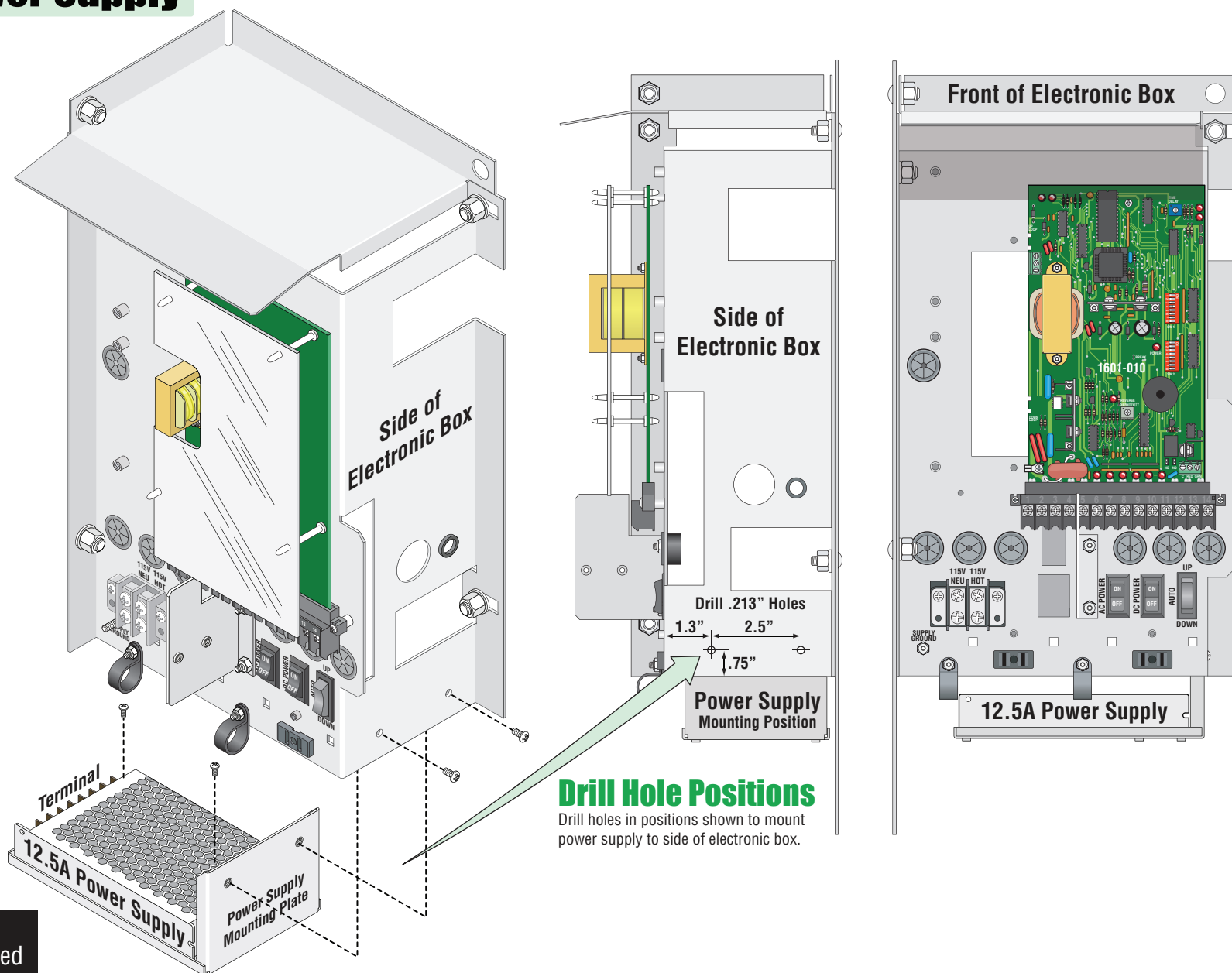

IMPORTANT: Power supply **MUST** be wired **BEFORE** mounting it as shown. See next page.

Mount Power Supply

**MAKE SURE ALL POWER IS
TURNED OFF TO OPERATOR!**

Optional
DKS Red/Green
LED Traffic
Light Kit
 Sold Separately

Red/
Brown

White

White

Traffic
Light
Terminal

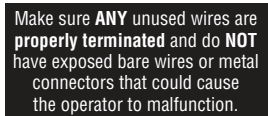

3-PIECE OCTAGON ARM ONLY INSTALL

These 3-Piece Arm ONLY are designed **ONLY** for the 1602 model barrier gate operator.

IMPORTANT NOTE: Installation of arms WITH LED/Reverse Edge kit see pages 1-6.

DoorKing Part Numbers:

1602-282

20 ft Arm Only

1602-284

24 ft Arm Only

1602-287

27 ft Arm Only

Overview of Installation

Prior to beginning the installation of the 3-piece arms **ONLY**, see pages 7-9. We suggest that you become familiar with the instructions, illustrations on these pages.

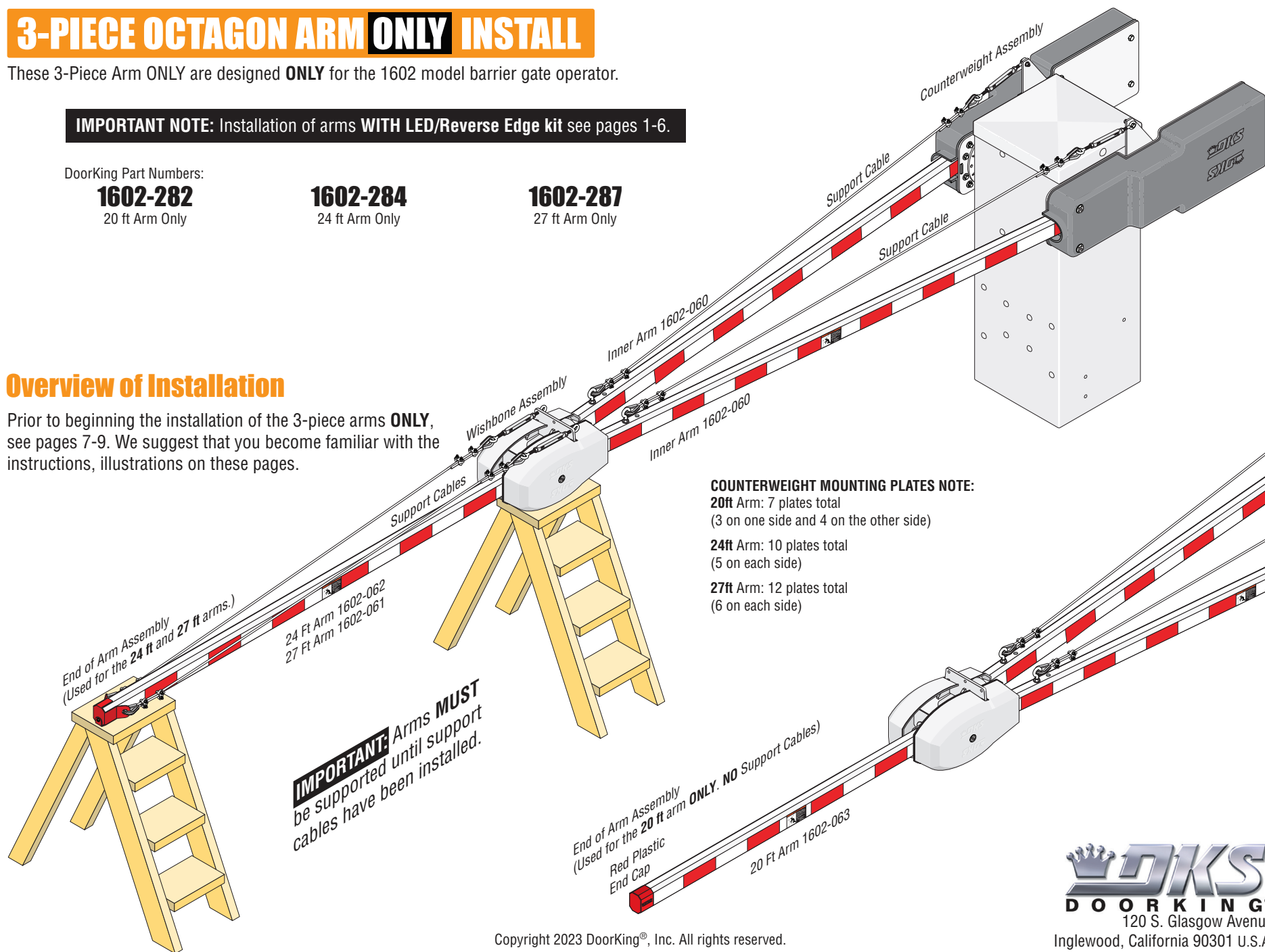

Mount hubs on operator **FIRST** Test hubs **UP** and **DOWN** positions **BEFORE** installing counterweight mounting plates, then assemble arms.

Mount hubs on operator **FIRST** Test hubs **UP** and **DOWN** positions **BEFORE** installing counterweight mounting plates, then assemble arms.

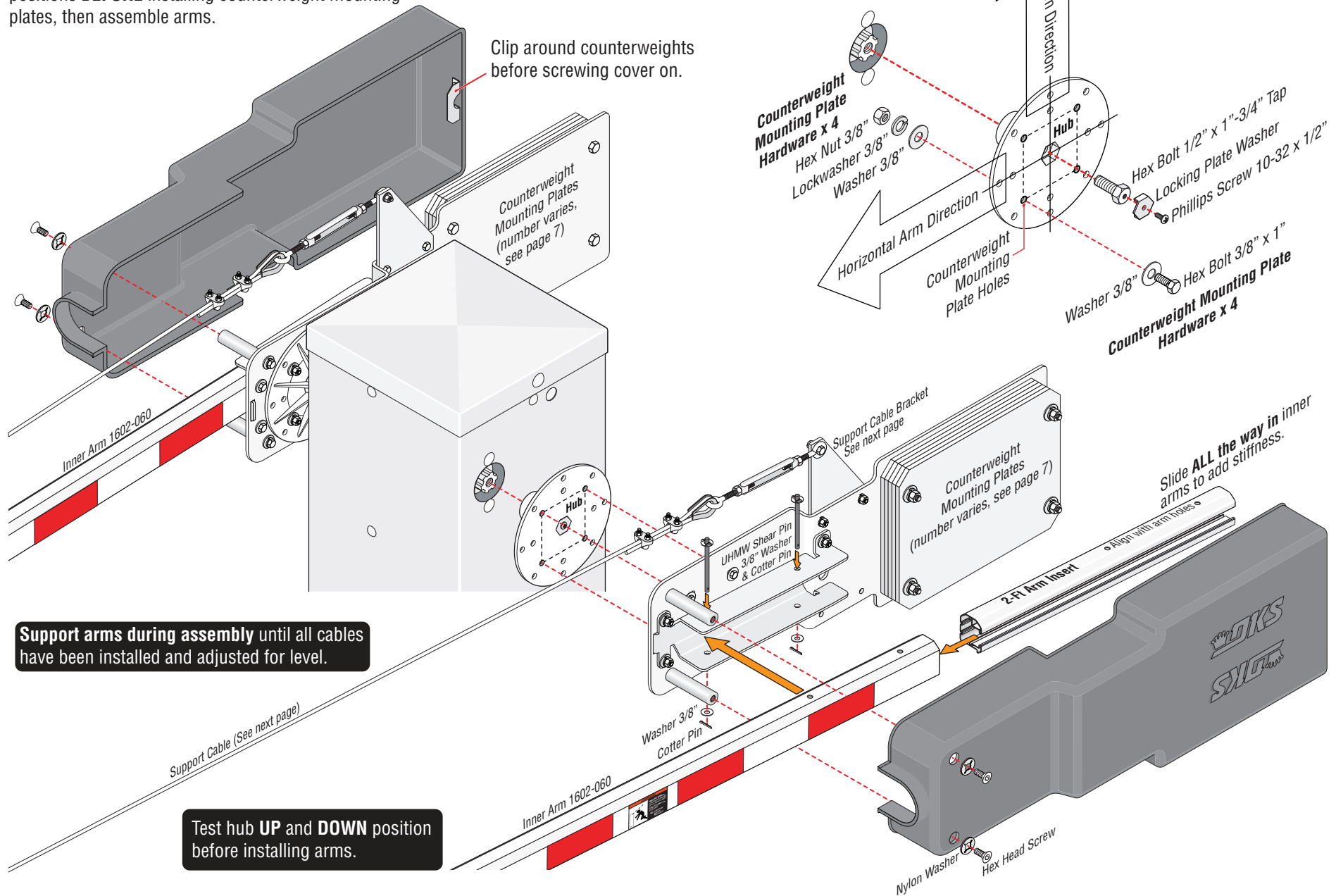

Support Cable Bracket Installation

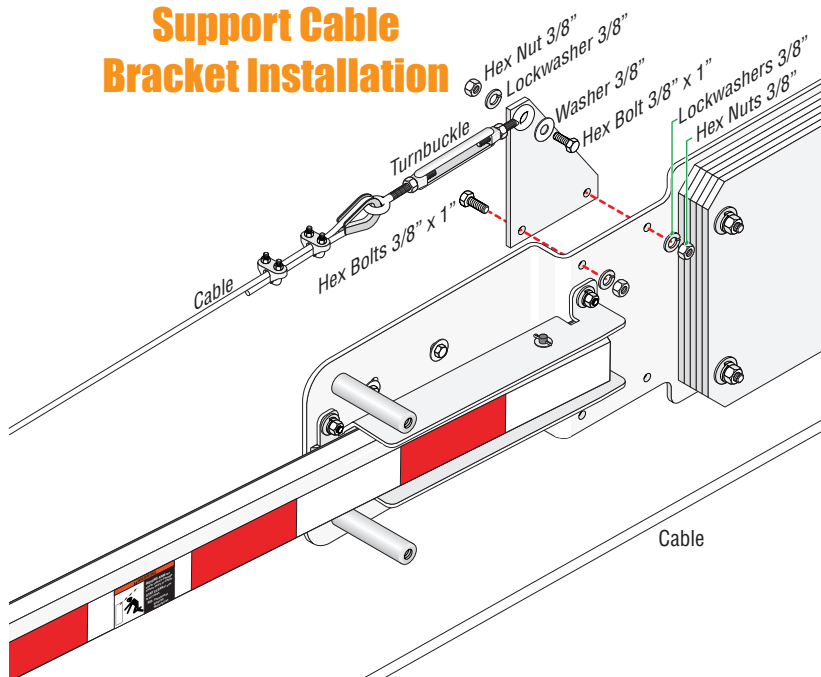

Typical Support Cable Installation

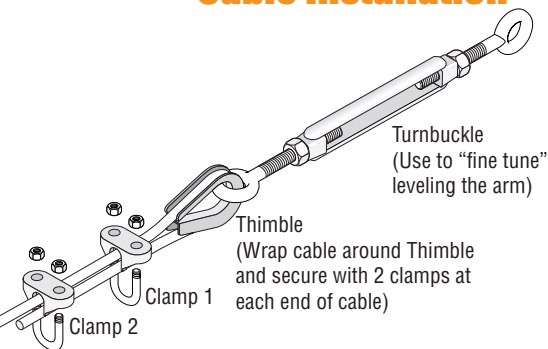

Inner Arms Assembly (Wishbone End)

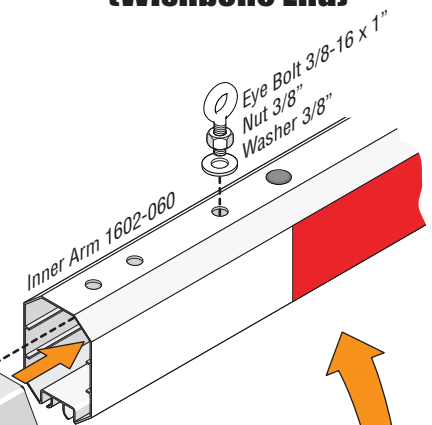

End of Arm Assembly

NOT used for the 20 ft arm.

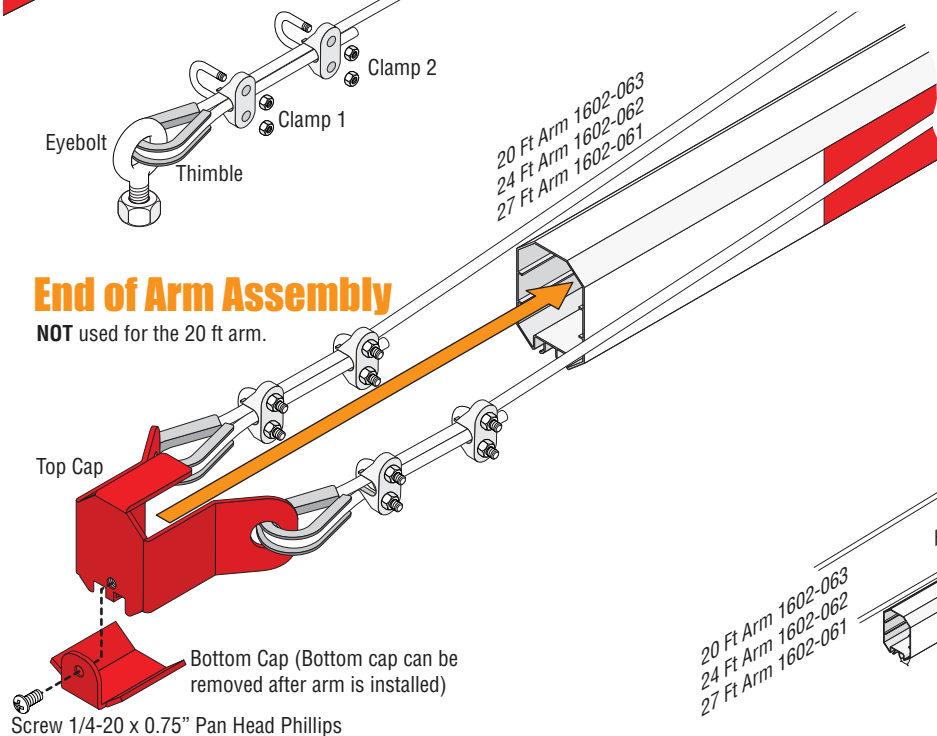

Attaching Turnbuckles to Wishbone 24 & 27 ft arms ONLY.

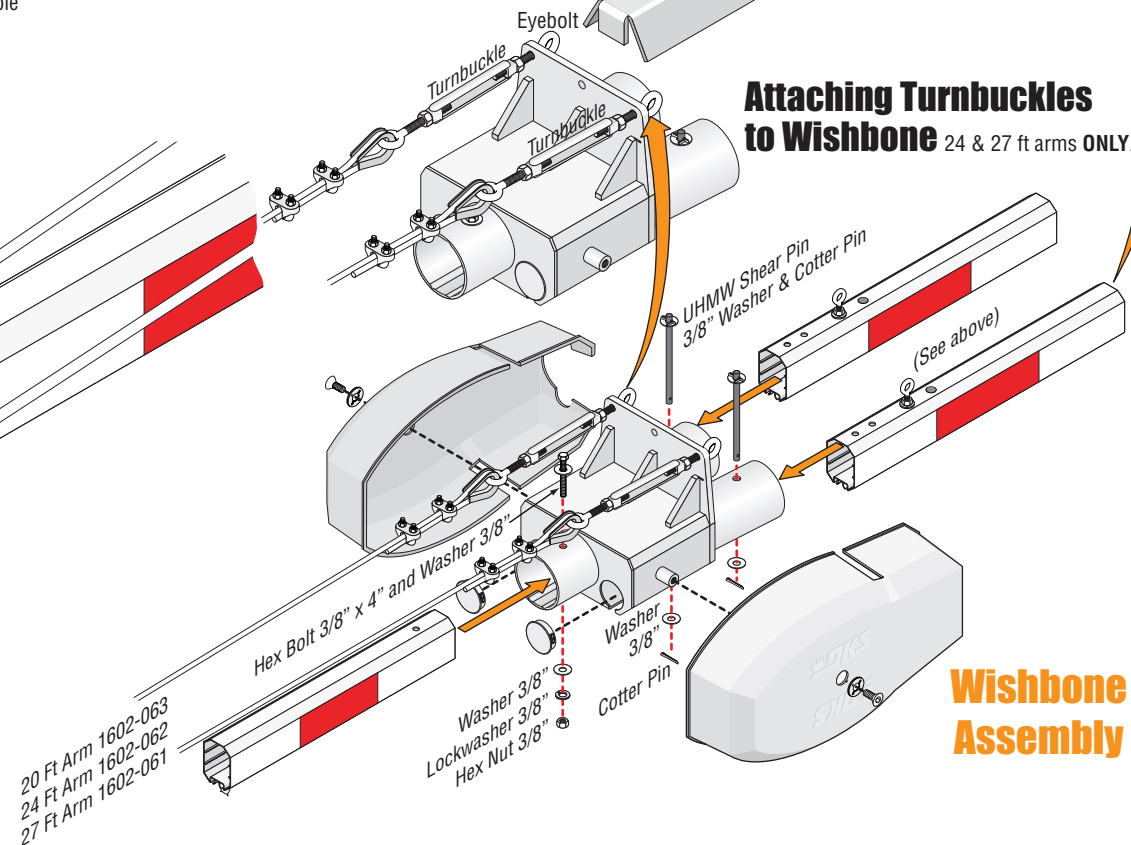

Wishbone Assembly