

LANE BARRIER INSTALLATION

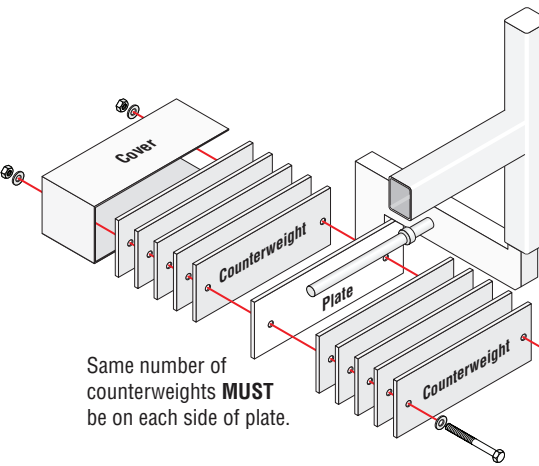

Secondary Barrier Arm Counterweight Assembly



- 9 ft Lane: Use 30 counterweights (15 on each side)
- 10 ft Lane: Use 32 counterweights (16 on each side)
- 12 ft Lane: Use 32 counterweights (16 on each side)
- 14 ft Lane: Use 34 counterweights (17 on each side)

Same number of counterweights **MUST** be on each side of plate.

Secondary Barrier Arm (Up Position)

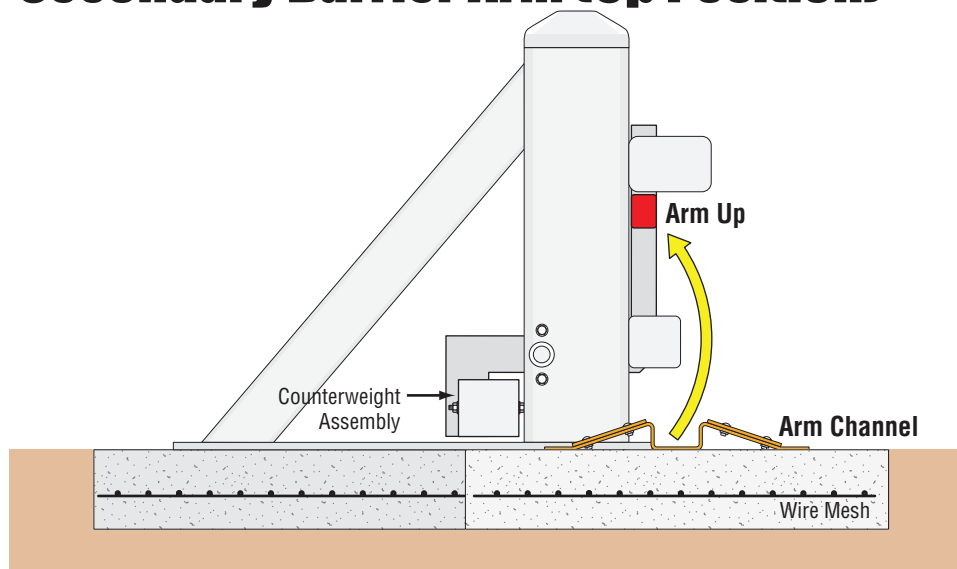

Secondary Barrier Arm (Down Position)

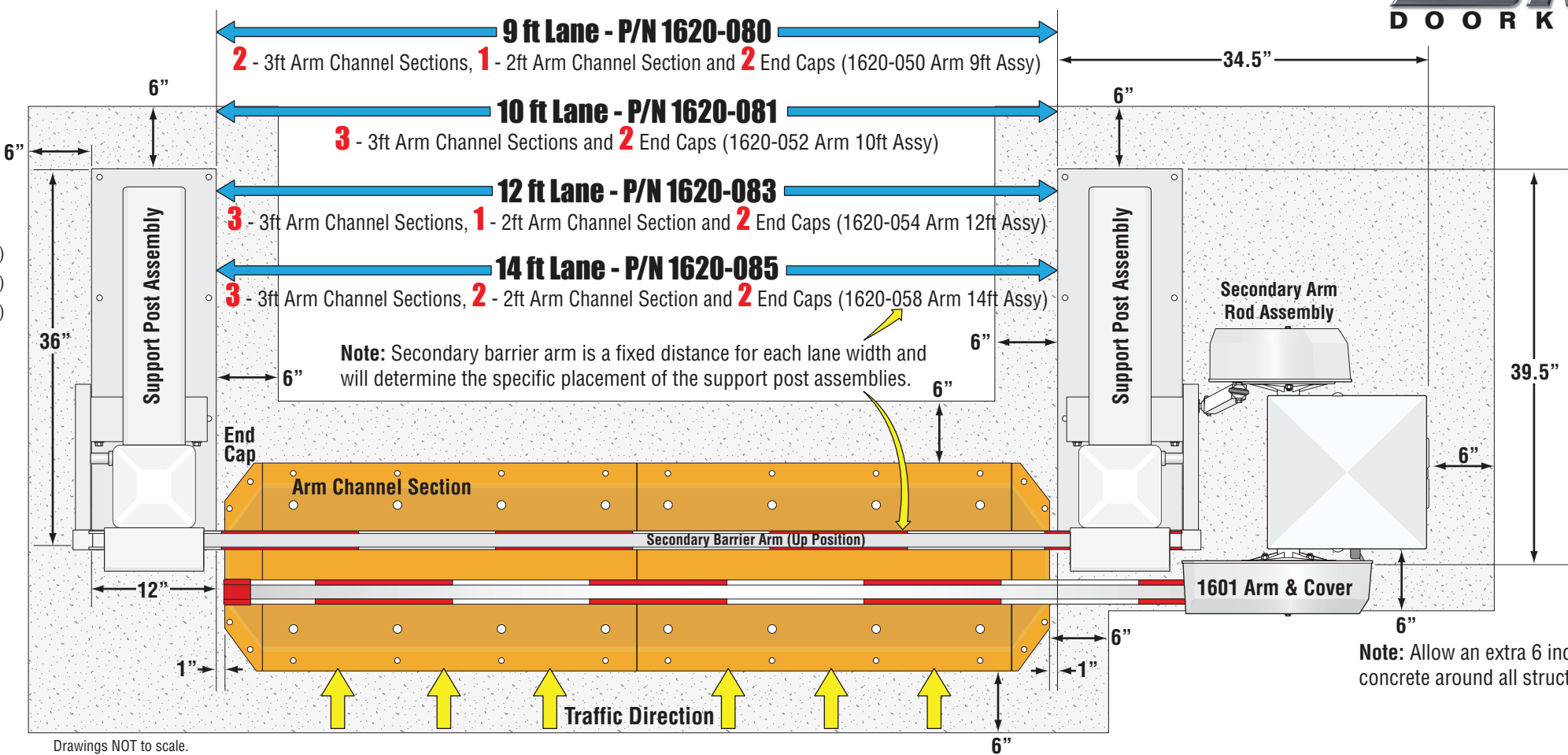
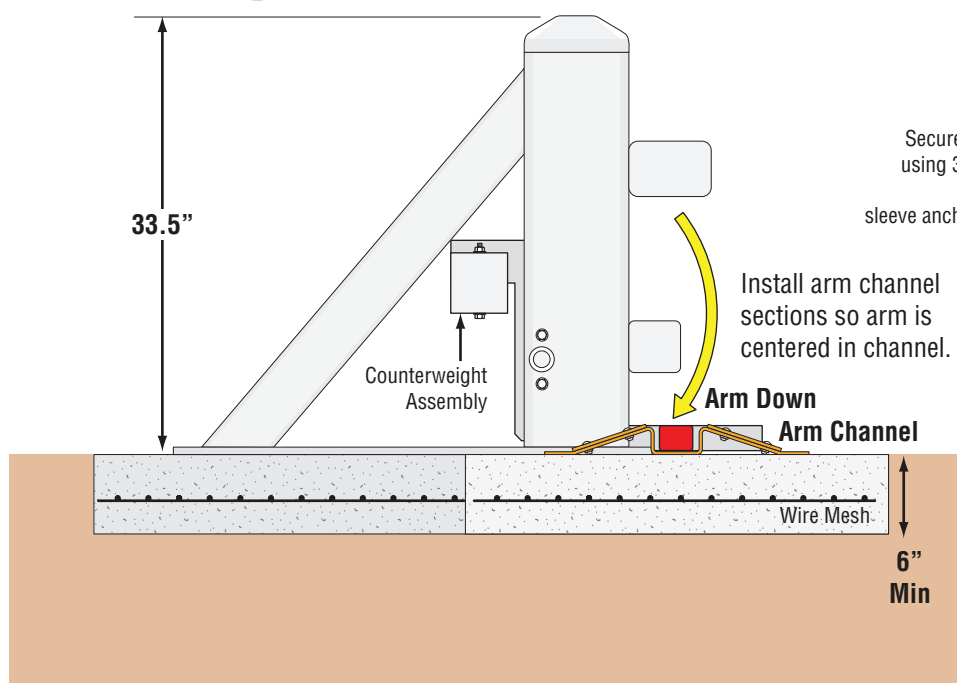

Drawings NOT to scale.

Note: Allow an extra 6 inches of concrete around all structures min.

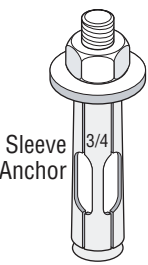

Secure all to the concrete using 3/4" x 3" minimum, 1" x 3" maximum sleeve anchors (not supplied).

Secondary Barrier Arm (Up Position)

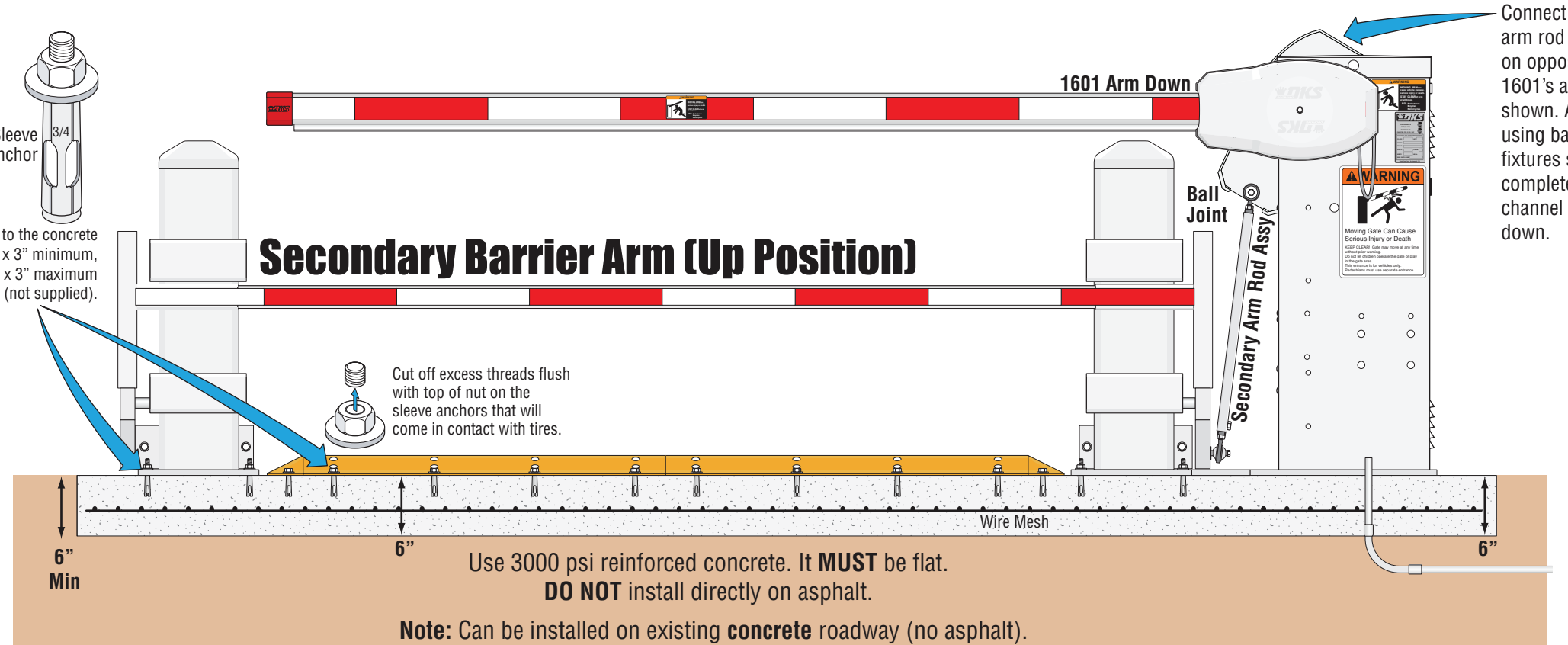

Connect secondary arm rod assembly on opposite side of 1601's arm as shown. Adjust using ball joint fixtures so arm lays completely in channel when down.

LANE BARRIER OPERATION

- 9 Ft Lane P/N 1620-080
- 10 Ft Lane P/N 1620-081
- 12 Ft Lane P/N 1620-083
- 14 Ft Lane P/N 1620-085

IMPORTANT SAFETY INFORMATION: The secondary barrier arm can produce high levels of force. It is important that you are aware and eliminate possible HAZARDS; Pinch Points, Entrapment Areas, Overhead Power Wires, Absence of Controlled Pedestrian Access, and Traffic Management.

Note: The lane barrier **IS NOT** a crash rated system. It is designed to enhance traffic enforcement for standard barrier arms.



120 S. Glasgow Avenue
Inglewood, California 90301
U.S.A.

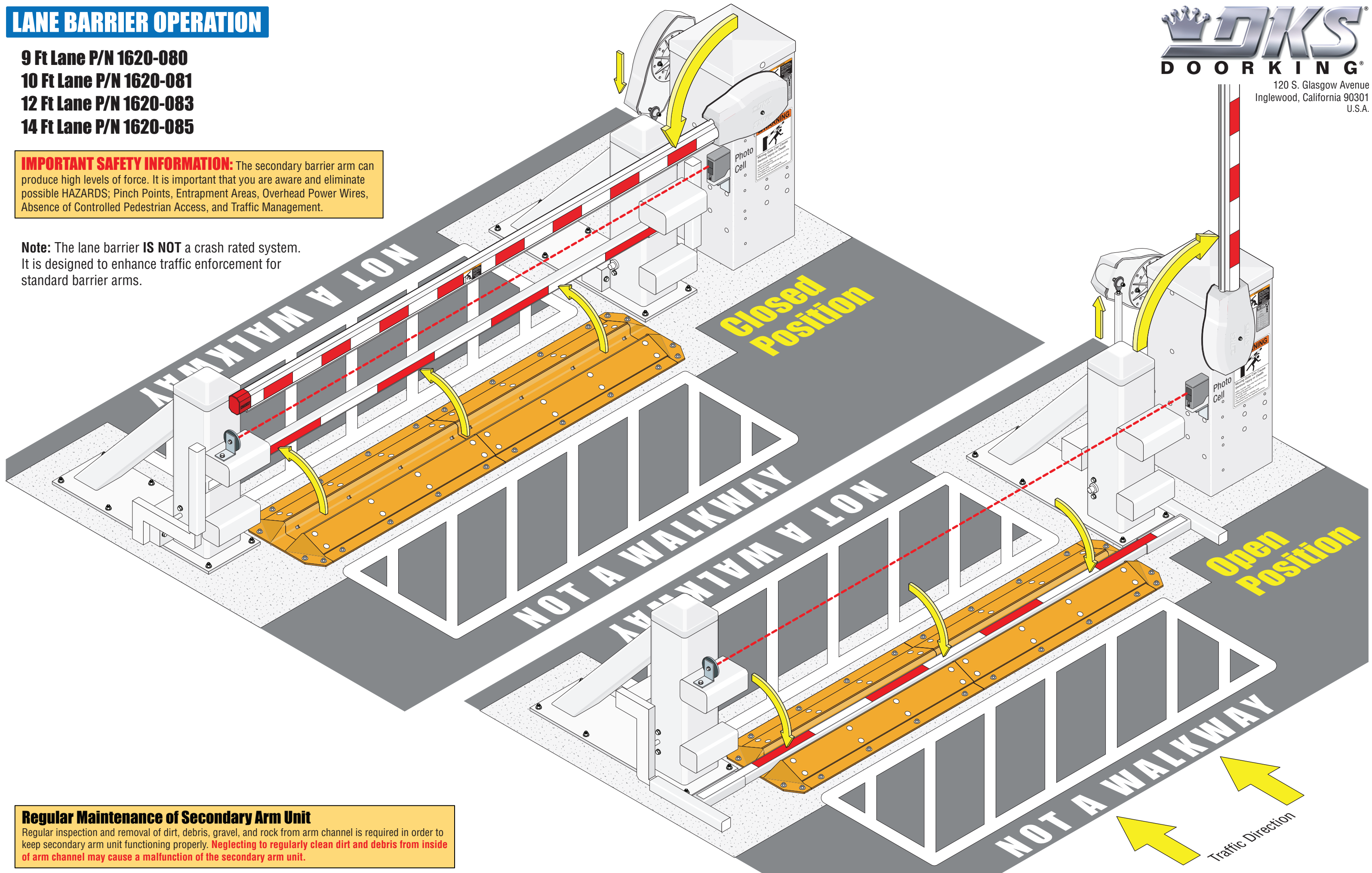

Regular Maintenance of Secondary Arm Unit

Regular inspection and removal of dirt, debris, gravel, and rock from arm channel is required in order to keep secondary arm unit functioning properly. **Neglecting to regularly clean dirt and debris from inside of arm channel may cause a malfunction of the secondary arm unit.**

