

TRAFFIC LIGHT AND MOUNTING KIT

DoorKing Part Number

1603-210

This kit is designed for the 1600 model barrier gate operators. Recommended for the 1603 auto spike system. The traffic signal is synchronized with the gate operator's up/down cycle. The red light stays on and only changes to green when the operator's arm is fully raised.

Kit Includes:

Plastic Traffic Light Assembly (Factory wired)
2" Threaded Support Post
Support Post Bracket
Bracket Cover.

Hardware:

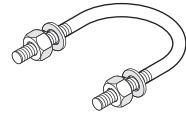

U-Bolt Clamp with lockwashers and nuts (2 sets)



3/4" Conduit Nipple and Conduit Nut

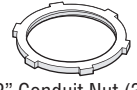

2" Conduit Nut (3)



5/8" Cover Bracket bolt and lockwasher (2 sets)

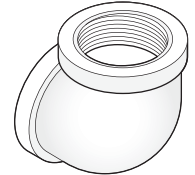

2" Threaded Elbow

Installation

! Shut off AC power to operator.
Turn off DC power switch on certain models.

1 Assemble Support Post

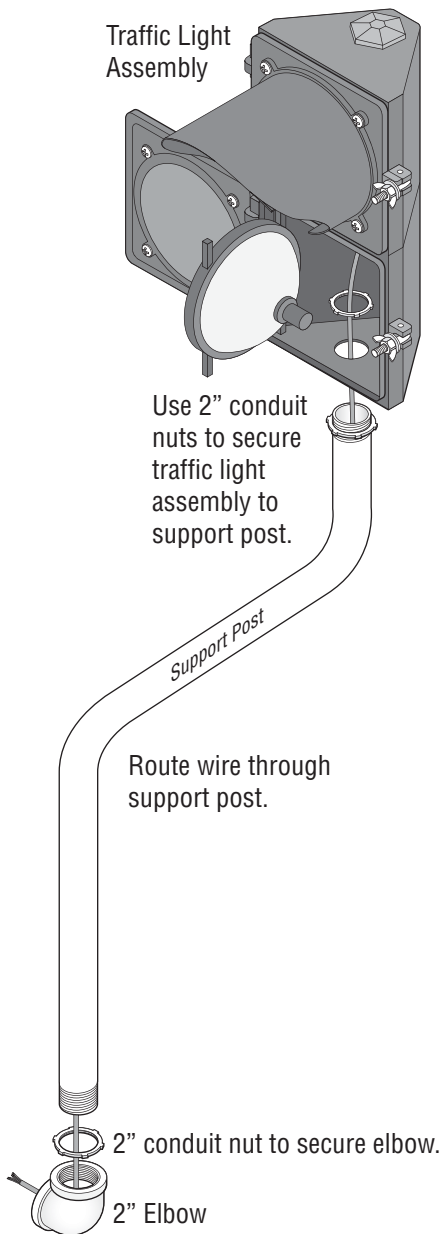

2 Mount Support Post Assembly to Operator

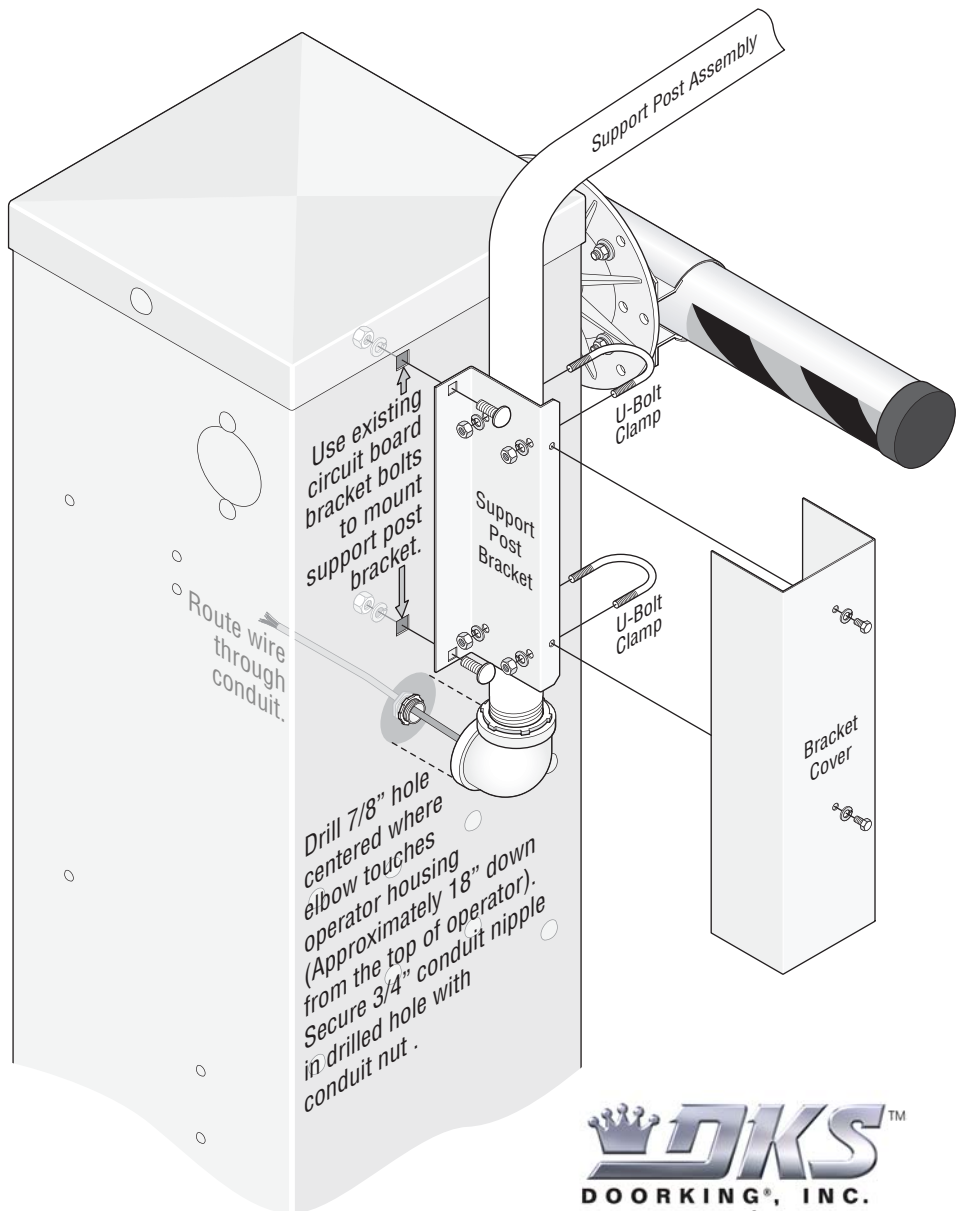

DKS™
DOORING®, INC.
120 Glasgow Avenue
Inglewood, California 90301 U.S.A.

3 Wire Traffic Light to Operator

DoorKing Part Number

1603-210

Note: This light has been designed to wire to operators that use 115 volt power and a FORM C dry relay contact that activates when the operator is fully open.

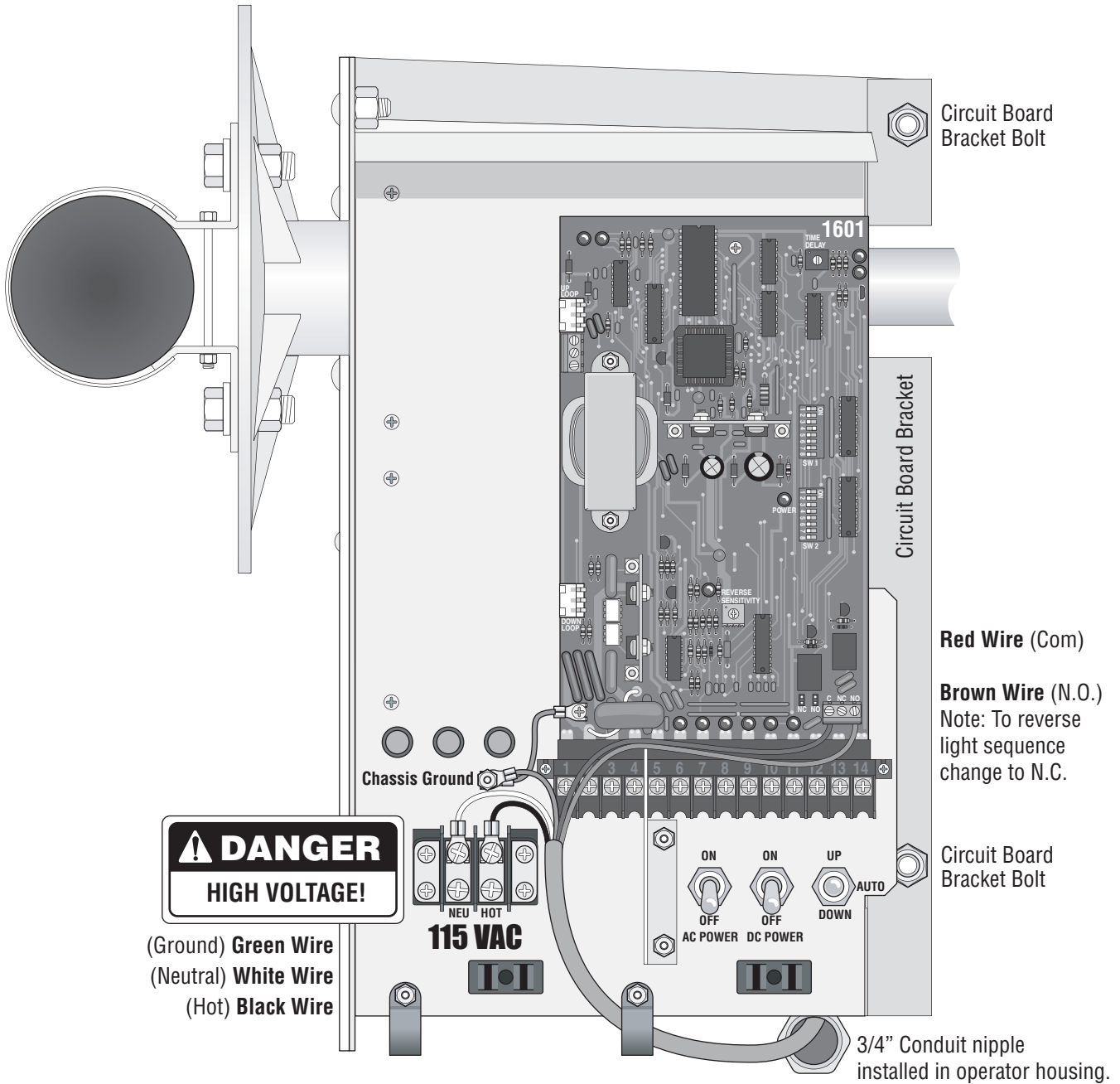

⚠ DANGER
HIGH VOLTAGE!

(Ground) **Green Wire**
(Neutral) **White Wire**
(Hot) **Black Wire**

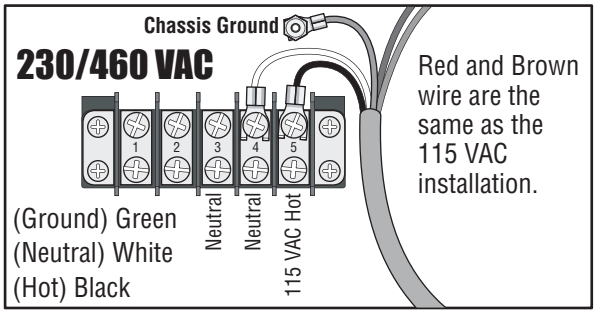

⚠ Keep wire clear of all moving parts.